



Dear VIZIO Customer,

Congratulations on your new VIZIO E 260VP television purchase. To get the most out of your new VIZIO HDTV, read these instructions before making any adjustments, and retain them for future reference. We hope you will experience many years of enjoyment from your new VIZIO HDTV High Definition Television.

For assistance, call **877-MYVIZIO** (877-698-4946) or e-mail us at [www.VIZIO.com](http://www.VIZIO.com).

To purchase or inquire about accessories and installation services for your VIZIO HDTV, visit our website at [www.VIZIO.com](http://www.VIZIO.com) or call toll free at **888-849-4623**.

We recommend you register your VIZIO HDTV either at our website [www.VIZIO.com](http://www.VIZIO.com) or fill out and mail your registration card. For peace of mind and to protect your investment beyond the standard warranty, VIZIO offers on-site extended warranty service plans. These plans give additional coverage during the standard warranty period. Visit our website or call us to purchase a plan.

Write down the serial number located on the back of your HDTV for easy reference when obtaining warranty support:

Serial #: _____	Purchase Date _____
-----------------	---------------------

*VIZIO is a registered trademark of VIZIO, Inc. dba V, Inc.*

*HDMI logo and "High Definition Multimedia Interface" are registered trademarks of HDMI Licensing LLC.*

*Manufactured under license from Dolby Laboratories.*

*Dolby and the double-D symbol are trademarks of Dolby Laboratories.*



*TruSurround HD and TruVolume are trademarks of SRS Labs, Inc.*

*TruSurround HD and TruVolume technologies are incorporated under license from SRS Labs, Inc.*



This product qualifies for ENERGY STAR in the "factory default (Home Use)" setting and this is the setting in which power savings will be achieved. Changing the factory default picture setting or enabling other features will increase power consumption that could exceed the limits necessary to qualify for Energy Star rating.

*THE TRADEMARKS SHOWN HEREIN ARE THE PROPERTY OF THEIR RESPECTIVE OWNERS; IMAGES USED ARE FOR ILLUSTRATION PURPOSES ONLY. VIZIO, THE V LOGO, WHERE VISION MEETS VALUE AND OTHER VIZIO TRADEMARKS ARE THE INTELLECTUAL PROPERTY OF VIZIO INC. PRODUCT SPECIFICATIONS ARE SUBJECT TO CHANGE WITHOUT NOTICE. © 2011 VIZIO INC. ALL RIGHTS RESERVED.*

## Important Safety Instructions

Your HDTV is designed and manufactured to operate within defined design limits. Misuse may result in electric shock or fire. To prevent your HDTV from being damaged, the following rules should be observed for the installation, use, and maintenance of your HDTV. Read the following safety instructions before operating your HDTV. Keep these instructions in a safe place for future reference.

- To reduce the risk of electric shock or component damage, switch off the power before connecting other components to your HDTV.
- Unplug the power cord before cleaning your HDTV. A damp cloth is sufficient for cleaning your HDTV. Do not use a liquid or a spray cleaner for cleaning your HDTV. Do not use abrasive cleaners.
- Always use the accessories recommended by the manufacturer to insure compatibility.
- When moving your HDTV from an area of low temperature to an area of high temperature, condensation may form in the housing. Wait before turning on your HDTV to avoid causing fire, electric shock, or component damage.
- Use only with the cart, stand, tripod, bracket, or table specified by manufacturer or sold with your HDTV. When a cart is used, use caution when moving the cart/HDTV combination to avoid injury from tip-over. Do not place your HDTV on an unstable cart, stand, or table. If your HDTV falls, it can injure a person and cause serious damage to your HDTV. Use only a cart or stand recommended by the manufacturer or sold with your HDTV.
- A distance of at least three feet should be maintained between your HDTV and any heat source, such as a radiator, heater, oven, amplifier etc. Do not install your HDTV close to smoke. Operating your HDTV close to smoke or moisture may cause fire or electric shock.
- Slots and openings in the back and bottom of the cabinet are provided for ventilation. To ensure reliable operation of your HDTV and to protect it from overheating, be sure these openings are not blocked or covered. Do not place your HDTV in a bookcase or cabinet unless proper ventilation is provided.
- Never push any object into the slots and openings on your HDTV cabinet. Do not place any objects on the top of your HDTV. Doing so could short circuit parts causing a fire or electric shock. Never spill liquids on your HDTV.
- Your HDTV should be operated only from the type of power source indicated on the label. If you are not sure of the type of power supplied to your home, consult your dealer or local power company.
- Do not apply pressure or throw objects at your HDTV. This may compromise the integrity of the display. The manufacturer's warranty does not cover user abuse or improper installations.
- The power cord must be replaced when using different voltage than the voltage specified. For more information, contact your dealer.
- Your HDTV is equipped with a **three-pronged grounded plug (a plug with a third grounding pin)**. This plug will fit only into a grounded power outlet. This is a safety feature. If your outlet does not accommodate the three-pronged, have an electrician install the correct outlet, or use an adapter to ground your HDTV safely. **Do not defeat the safety purpose of the grounded plug.**
- When connected to a power outlet, power is always flowing into your HDTV. To totally disconnect power, unplug the power cord.



- The lightning flash with arrowhead symbol within an equilateral triangle is intended to alert the user to the presence of un-isolated, dangerous voltage within the inside of your HDTV that may be of sufficient magnitude to constitute a risk of electric shock to persons.



- The exclamation point within an equilateral triangle is intended to alert the user to the presence of important operating and servicing instructions in the literature accompanying your HDTV.
- Do not overload power strips and extension cords. Overloading can result in fire or electric shock.

- The wall socket should be installed near your HDTV and easily accessible.
- Only power of the marked voltage can be used for your HDTV. Any other voltage than the specified voltage may cause fire or electric shock
- Do not touch the power cord during lightning. To avoid electric shock, avoid handling the power cord during electrical storms.
- Unplug your HDTV during a lightning storm or when it will not be used for long period of time. This will protect your HDTV from damage due to power surges.
- Do not attempt to repair or service your HDTV yourself. Opening or removing the back cover may expose you to high voltages, electric shock, and other hazards. If repair is required, contact your dealer and refer all servicing to qualified service personnel.
- Keep your HDTV away from moisture. Do not expose your HDTV to rain or moisture. If water penetrates into your HDTV, unplug the power cord and contact your dealer. Continuous use in this case may result in fire or electric shock.
- Do not use your HDTV if any abnormality occurs. If any smoke or odor becomes apparent, unplug the power cord and contact your dealer immediately. Do not try to repair your HDTV yourself.
- Avoid using dropped or damaged appliances. If your HDTV is dropped and the housing is damaged, the internal components may function abnormally. Unplug the power cord immediately and contact your dealer for repair. Continued use of your HDTV may cause fire or electric shock.
- Do not install your HDTV in an area with heavy dust or high humidity. Operating your HDTV in environments with heavy dust or high humidity may cause fire or electric shock.
- Follow instructions for moving your HDTV. Ensure that the power cord and any other cables are unplugged before moving your HDTV.
- When unplugging your HDTV, hold the power plug, not the cord. Pulling on the power cord may damage the wires inside the cord and cause fire or electric shock. When your HDTV will not be used for an extended period of time, unplug the power cord.
- To reduce risk of electric shock, do not touch the connector with wet hands.
- Insert batteries in accordance with instructions. Incorrect polarities may cause the batteries to leak which can damage the remote control or injure the operator.
- If any of the following occurs, contact the dealer:
  - The power cord fails or frays.
  - Liquid sprays or any object drops into your HDTV.
  - Your HDTV is exposed to rain or other moisture.
  - Your HDTV is dropped or damaged in any way.
  - The performance of your HDTV changes substantially.

## Television Antenna Connection Protection

### External Television Antenna Grounding

If an outside antenna/satellite dish or cable system is to be connected to the TV, make sure that the antenna or cable system is electrically grounded to provide some protection against voltage surges and static charges.

Article 810 of the National Electrical Code, ANSI/NFPA 70, provides information with regard to proper grounding of the mast and supporting structure, grounding of the lead-in wire to an antenna discharge unit, size of the grounding conductors, location of antenna discharge unit, connection to grounding electrodes, and requirements of the grounding electrode.

### Lightning Protection

For added protection of the TV during a lightning storm or when it is left unattended or unused for long periods of time, unplug the TV from the wall outlet and disconnect the antenna or cable system.

### Power Lines

Do not locate the antenna near overhead light or power circuits, or where it could fall into such power lines or circuits.

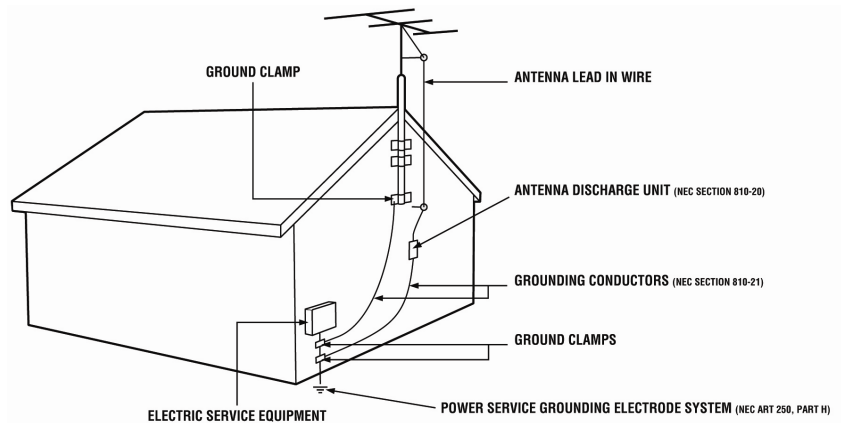

**Remember, the screen of the coaxial cable is intended to be connected to earth in the building installation.**

## Advisory of the DTV Transition

The nationwide switch to digital television broadcasting will be complete on June 12, 2009, but your local television stations may switch sooner. After the switch, analog-only television sets that receive TV programming through an antenna will need a converter box to continue to receive over-the-air TV. Watch your local stations to find out when they will turn off their analog signal and switch to digital-only broadcasting. Analog-only TVs should continue to work as before to receive low power, Class A or translator television stations and with cable and satellite TV services, gaming consoles, VCRs, DVD players, and similar products.

For additional information, contact the parties listed below, as appropriate:

FCC (US Federal Communications Commission)

<http://www.fcc.gov/>

Phone: 1-888-CALL-FCC (1-888-225-5322)

TTY: 1-888-TELL-FCC (1-888-835-5322)

Fax: 1-866-418-0232

E-mail: [fccinfo@fcc.gov](mailto:fccinfo@fcc.gov)

NTIA (National Telecommunications and Information Administration)

<http://www.ntia.doc.gov/>

1-888-DTV-2009

Listings of US Television Stations

<http://www.high-techproductions.com/usTVstations.htm>

**Note:** Your VIZIO HDTV is capable of receiving Digital Broadcasts, and no Digital Converter Box is required.

**Table of Contents**

Important Safety Instructions ..... 2  
 Television Antenna Connection Protection ..... 4  
 Advisory of the DTV Transition ..... 5

**CHAPTER 1 SETTING UP YOUR HDTV ..... 10**

Finding a Location for Your HDTV ..... 10  
 Attaching the TV Stand ..... 11  
 Wall Mounting your HDTV ..... 12

**CHAPTER 2 BASIC CONTROLS AND CONNECTIONS ..... 13**

Front Panel ..... 13  
 Side Button Controls ..... 13  
 Side Panel Connections ..... 14  
 Rear Panel Connections ..... 14

**CHAPTER 3 VIZIO REMOTE CONTROL ..... 15**

Installing the Batteries ..... 15  
 Remote Control Range ..... 15  
 VIZIO Remote Control Precautions ..... 15  
 Remote Control Buttons ..... 16

**CHAPTER 4 GETTING STARTED ..... 17**

**CHAPTER 5 USING YOUR HDTV FOR THE FIRST TIME ..... 18**

Select an Input Source ..... 18  
 Watching a TV Program ..... 18  
 Viewing Digital TV Program Information ..... 19

**CHAPTER 6 CONNECTING EQUIPMENT ..... 20**

Which Video Connection Should I Use? ..... 20  
 Connecting Your Cable or Satellite Box ..... 21  
     Using HDMI (Best) ..... 21  
     HDMI Connections for Cable or Satellite Boxes with DVI ..... 22  
     Using Composite Video (Good) ..... 22  
     Using Coaxial (Antenna) (Good) ..... 23  
 Connecting Your DVD Player ..... 23  
     Using HDMI (Best) ..... 23  
     HDMI Connections for DVD Players with DVI ..... 24  
     Using Composite (AV) Video (Good) ..... 24  
 Connecting Coaxial (RF) ..... 25  
     Using Your Antenna or Digital Cable for Standard or Digital TV ..... 25  
 Connecting Your VCR or Video Camera ..... 25  
 Connecting a Home Theater System ..... 26  
 Using Optical (S/PDIF) ..... 26  
 Connecting a Computer ..... 26  
     RGB (VGA) ..... 26  
     Using HDMI ..... 27

**CHAPTER 7 VIEWING PICTURES ..... 28**

Viewing Pictures ..... 28  
 Adjusting Photo Settings ..... 29  
     Slideshow Mode ..... 29  
     Repeat ..... 29  
     Sort By ..... 29

Duration .....	29
Slideshow Effect .....	29
Thumbnail Size .....	29
Info .....	29
<b>CHAPTER 8 ADJUSTING YOUR HDTV SETTINGS.....</b>	<b>30</b>
Using the On-screen Display (OSD) .....	30
Input Menu.....	30
Wide Menu .....	31
Normal.....	31
Wide .....	31
Panoramic.....	31
Stretch.....	31
CC (Closed Caption) Menu .....	32
Adjust closed caption options.....	32
Analog Closed Caption .....	32
Digital Closed Caption .....	32
Digital CC Style.....	32
Sleep Timer Menu .....	32
Picture Menu .....	32
Picture Mode.....	32
Backlight .....	32
Brightness .....	32
Contrast .....	33
Color.....	33
Tint .....	33
Sharpness.....	33
More .....	33
Audio Menu .....	35
Audio Mode.....	35
Balance .....	35
Lip Sync .....	35
TV Speakers .....	35
Advanced Audio.....	35
Equalizer Settings.....	36
Reset Audio Mode .....	36
Settings Menu.....	36
Tuner.....	36
Partial Channel Search.....	36
Name Input .....	37
Parental Controls .....	38
Menu Language.....	40
Time & Local Settings.....	40
CEC.....	40
Media Menu.....	41
Slideshow Mode.....	41
Repeat.....	41
Sort By .....	41
Duration .....	41
Slideshow Effect .....	41
Thumbnail Size .....	41
Info .....	41
Help Menu .....	42
System Info .....	42
Reset TV Settings.....	42
Clear Memory (Factory Default) .....	42

Start Setup Wizard ..... 42

**CHAPTER 9 MAINTENANCE AND TROUBLESHOOTING ..... 43**

    Cleaning the TV and Remote Control ..... 43

    Troubleshooting Guide ..... 43

    Telephone & Technical Support ..... 46

    Compliance..... 46

    FCC Class B Radio Interference Statement ..... 46

**CHAPTER 10 SPECIFICATIONS ..... 47**

    Preset PC Resolutions ..... 49

    Resolution through RGB Input ..... 49

**WARRANTY ..... 50**

    Index ..... 51



## Opening the Package

Your HDTV and its accompanying accessories are carefully packed in a cardboard carton that has been designed to protect it from transportation damage. After you have opened the carton, check that your HDTV is in good condition and that all of the contents are included.

The glass surface can easily be scratched or broken, so handle your HDTV gently and never place your HDTV with the glass facing downwards on a surface without protective padding.

**IMPORTANT:** Save the carton and packing material for future shipping.

## Package Contents

- VIZIO E260VP
- VIZIO remote control
- AA batteries for the remote control (2)
- Power Cord
- Detachable base with thumbscrew
- This user manual
- Quick Setup Guide
- Registration Card



## HDTV Accessories and Services

Additional certified accessories for your HDTV are sold separately, including:

- Wall mounts
- High Definition cables
- Extra or replacement remote controls
- Sound Bars
- Blu-ray DVD Players

VIZIO also offers installation services and extended warranty services for your HDTV.

To purchase or inquire about additional accessories and services for your VIZIO HDTV, visit our website at [www.VIZIO.com](http://www.VIZIO.com) or call us toll free at **877-MYVIZIO** (877-698-4946).

**Caution:** Do not apply pressure or throw objects at your HDTV (including game controllers). This may compromise the integrity of the display. The manufacturer's warranty does not cover user abuse or improper installations.

## Chapter 1 Setting Up Your HDTV

### Finding a Location for Your HDTV

Here are some things you should consider when deciding on a proper location for your HDTV:

- The power consumption of your HDTV is about 32.8W (AVG)
  - Use the included power cord.
  - When an extension cord is required, use one with the correct power rating. The 3-pronged cord must be grounded and the grounding feature (3<sup>rd</sup> prong) must not be compromised.
- Install your HDTV on a flat surface to avoid tipping.
- For proper ventilation, you must allow space between the back of your HDTV and the wall.
- Avoid installing your HDTV in places with high humidity, dust, or smoke so you do not shorten the service life of the electronic components.
- Install your HDTV in a level, landscape orientation, with the VIZIO logo at the bottom to prevent poor ventilation and excessive component damage.
- If you want to mount your HDTV on the wall, see below for additional information.
- Read this user manual carefully before installing your HDTV.

VIZIO offers professional installation services including home networking. Contact VIZIO for more information on these services at **877-MYVIZIO** (877-698-4946) or [www.VIZIO.com](http://www.VIZIO.com).

## Attaching the TV Stand

**Note:** We strongly recommend that two people perform the setup and assembly due to the weight and size of the TV.

### Unpack the TV and stand base:

1. Remove the two top foam end caps.
2. Remove the stand base and accessory box from packaging.
3. Remove the TV from the box and lay it face down on a clean, padded, flat surface.

**Note:** Make sure that the surface is free of debris to prevent the TV screen from getting scratched.

### Attach the TV stand base:

1. Align the stand base to the stand neck already attached to the TV.
2. Slide the base on and tighten the thumb screw to secure.



## Wall Mounting your HDTV

Your HDTV can be mounted on the wall for viewing. If you choose to mount your HDTV on the wall, follow the instructions below.

1. Write down the serial number located on the back of your HDTV in the space provided on page 1 to have it handy if you need to call for support.
2. Remove the stand base and neck:
  - a. Disconnect the cables from your HDTV.
  - b. Place your HDTV face down on a soft, flat surface to prevent damage to the screen.
  - c. Remove the cover on the stand neck.
  - d. Remove the four (4) screws holding the stand neck, and then remove the neck and base.

**Note:** To remove the base from the neck, unscrew thumbscrew on bottom.

3. Mount your HDTV on the wall:
  - a. Attach your HDTV to a wall mount (sold separately) using the mounting holes in the back panel of your HDTV.
  - b. Read the instructions that came with your specific wall mount to properly hang your HDTV.



Wall Mounting Specifications	
Screw Size	M4
Screw Length	12.0 mm
Screw Pitch	0.7 mm
Hole Pattern	VESA standard 75 x 75 mm spacing

## Chapter 2 Basic Controls and Connections

### Front Panel

1. **POWER 'VIZIO' LIGHT**—The VIZIO name lights white when powered on and silver when powered off.
2. **Remote Control Sensor**—Point the remote control directly at this window on the lower left corner of your HDTV for the best response to the remote signal.



### Side Button Controls



**POWER** (  )—Turn your HDTV on by pressing the button once. Press the button again to turn your HDTV off.

**MENU**—Press to launch the on-screen menu. If a sub-menu is active, this button will proceed to the next level.

**CH ▲/▼**—Press to change the channels up or down. While the menu is active, these buttons function as up and down controls.

**VOL +/-** —Press to increase or decrease the speaker volume. While the menu is active, these buttons function as left and right controls.

**INPUT (SELECT)**—Press to cycle through the various devices connected to your TV (called Inputs). The inputs cycle in the following sequence: TV, Comp/AV (Composite), RGB/Comp, HDMI-1, HDMI-2, and Media. After you have stepped through the entire sequence, you will return to the beginning. If a sub-menu is active, pressing this button will return to the previous menu level. Additionally, when the menu is active, this button confirms the menu function to be adjusted.

## Side Panel Connections

1. **HDMI 1 and 2** —Connect digital video devices such as a DVD player or Set-Top Box through this all digital connector.
2. **Component (Y Pb/Cb Pr/Cr with L/R Audio)**—
  - Connect Component video devices like Blu-ray/DVD players, or a Cable/ Satellite box here.
  - You can also connect Composite (A/V) video devices such as camcorders and VCRs here. Connect the yellow video cable to the green Component Y port and then connect the red and white audio cables to the R/L ports.
3. **DTV/TV**— Connect to an antenna or digital cable source. For digital TV stations in your area visit [www.antennaweb.org](http://www.antennaweb.org). For Cable and Satellite Set Top Boxes, we recommend that you use a HDMI connection for high definition image quality.

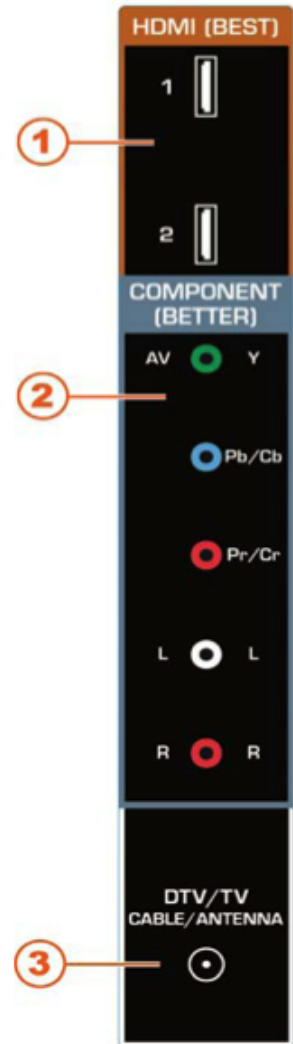

## Rear Panel Connections

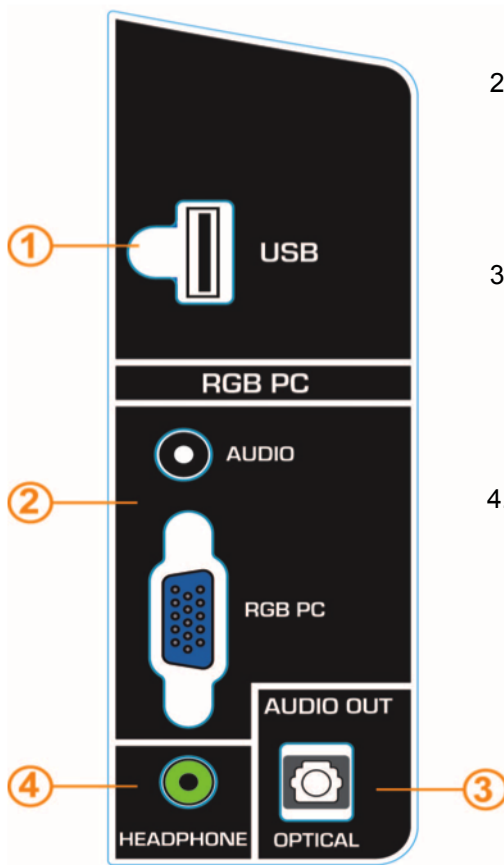

1. **USB**— Insert a FAT/FAT32 formatted USB drive to view pictures or for use by a professional service technician for service.
2. **RGB PC**—Connect the video and audio from a computer here. Connect a 1/8" mini plug stereo connector from the computer to the TV if you want the sound to come from the HDTV speakers.
3. **AUDIO OUT: OPTICAL**—When digital TV is selected for viewing, the audio associated with the programming will be available on the S/PDIF Optical connector for connection to a VIZIO Sound Bar or your Home Theater system.
4. **HEADPHONE**: Insert a 3.5 mm headphone connector to listen to the TV's audio via headphones.

## Chapter 3 VIZIO Remote Control

### Installing the Batteries

1. Remove the battery cover.
2. Insert two AA batteries into the remote control. Make sure that you match the (+) and (-) symbols on the batteries with the (+) and (-) symbols inside the battery compartment.
3. Replace the battery cover.



### Precautionary Tips for Inserting the Batteries:

- Only use AA batteries.
- Do not mix new and old batteries. This may result in cracking or leakage that may cause a fire or lead to personal injury.
- Inserting the batteries incorrectly may also result in cracking or leakage that may cause a fire or lead to personal injury.
- Dispose of batteries according to local hazardous waste regulations.
- Keep the batteries away from children and pets.

### Remote Control Range

- Point the remote control directly at this sensor for the best response to the remote signal.
- Do not place any obstacles between the remote control and the remote control sensor.
- The effective range of the remote control is approximately 22 feet (7 meters) from the front of the remote control sensor, 30° to the left and right, 20° up and down.



### VIZIO Remote Control Precautions

- The remote control should be kept dry and away from heat sources. Avoid humidity.
- If the TV responds erratically to the remote control or does not respond at all, check the batteries. If the batteries are low or exhausted, replace them with fresh batteries.
- When not using the remote control for a long period of time, remove the batteries.
- Do not take the batteries apart, heat them, or throw them into a fire.
- Do not subject the remote control to undue physical stress, such as striking or dropping it.
- Do not attempt to clean the remote control with a volatile solvent. Wipe it with a clean, damp cloth.

## Remote Control Buttons

**POWER** (  )—Press to turn the TV on from the Standby mode. Press it again to return to the Standby mode.

### CEC-Supported Buttons:

CEC needs to be set up and enabled for these buttons to work. See CEC section on page 40 for more information.

- (Record)—Press to begin recording on your CEC-supported device.
- ⏸ (Pause)—Press to pause playback on your CEC-supported device.
- ▶ (Play)—Press to start Playback on your CEC-supported device.
- (Stop)—Press to stop playback/recording on your CEC-supported device.
- ⏮ (Previous)—Press to skip the previous track on your CEC-supported device.
- ◀ (Reverse)—Press to reverses playback on your CEC-supported device.
- ▶▶ (Fast Forward)—Press to fast forward playback on your CEC-supported device.
- ▶▶ (Next)—Press to skip to the next chapter on your CEC-supported device.

**EXIT**—Press to exit from open menus.

**MENU**—Press to open the On-Screen Display (OSD) menu.

**OK**—Press this button to display the Channel List. Press to confirm selections for On-Screen Display (OSD) menus.

▲ ▼ ◀ ▶—Press to navigate the OSD menu. They will also be used as value settings when the slide bar is shown on the screen and option settings to turn a feature off or on.

**BACK**—Press to return to a previous OSD menu. Press repeatedly to close the OSD.

**GUIDE**—Press to display detailed program information when viewing a digital TV program.

### Color Buttons (Yellow, Blue, Red, & Green):

**Yellow**—This button performs the same function as the “A” button on your Cable or Satellite box when using the remote to control your pre-programmed Cable/Satellite Box DVR.

**Blue**—This button performs the same function as the “B” button on your Cable or Satellite box when using the remote to control your pre-programmed Cable/Satellite Box DVR.

**Red**—This button performs the same function as the “C” button on your Cable or Satellite box when using the remote to control your pre-programmed Cable/Satellite Box DVR.

**Green**—This button performs the same function as the “D” button on your Cable or Satellite box when using the remote to control your pre-programmed Cable/Satellite Box DVR.

**VOL +/-** —Press to turn the volume up or down.

**MEDIA** – Use this button to access the USB drive to view your pictures.

**MUTE**—Press to turn the sound on and off.

**LAST**— Press to recall the previously viewed channel.

**CH +/-** —Press to change the channels up or down

**HDMI**—Press to select the HDMI input. Press repeatedly to cycle between both HDMI inputs.





**AV**—Press to select the AV input.

**TV**—Press to select the TV input.

**Number Button Pad**—Press to select a channel or enter a password.

**INPUT**—Press to cycle through the various devices connected to your TV (called Inputs). After you have stepped through the entire sequence, you will return to the beginning.

- (**DASH**)—Press to insert a dash between the main and sub-channels. For example, channel 28-2 would be selected by the button sequence 2, 8, DASH, 2.

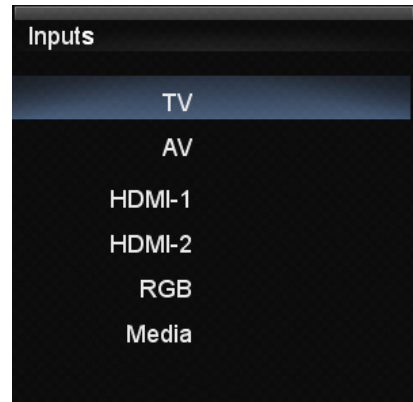

## Chapter 4 Getting Started

Your HDTV has a built-in setup App that runs when you turn on your TV for the first time. Follow the on-screen directions to easily setup your new HDTV.

1. Insert the batteries into the remote control.
2. Connect the power cord to the power cord connector on the back of your HDTV, and then plug the power cord into an AC wall socket.
3. Connect your devices to your HDTV (see Chapter 2 for detailed steps).
4. Turn on your TV. The Setup App will automatically play and guide your thru the initial setup of your HDTV. Use the Arrow and OK buttons to navigate through the setup App. During the setup process you will:
  - Choose your Menu language
  - Set the TV to Home Mode for the best picture and most efficient energy usage.
  - Set your Time Zone and Daylight Savings preferences
  - Add your TV channels (unless you have a Cable/Satellite Set-Top Box)

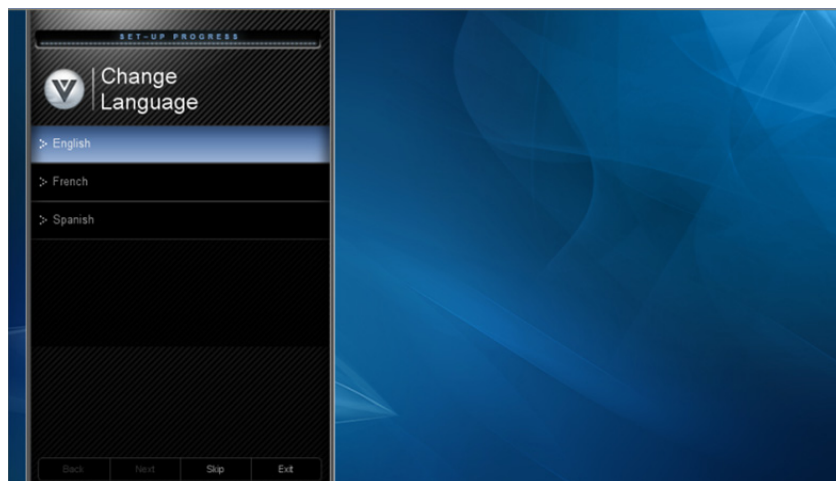

## Chapter 5 Using your HDTV for the first time

### Select an Input Source

Select the input source for your HDTV by pressing the **INPUT** button on the remote control or the front of your TV.

Turn on your device and you will see a picture on your HDTV. If there is no picture, make sure you have selected the correct input on your HDTV.

**Note:** If the selected device is RF connected, your HDTV needs to be in **TV** mode and on either channel 3 or channel 4 matching the channel which has been selected on the back of the VCR, Cable Box, External TV Tuner or Satellite Receiver. Refer to Owner or User's Manual of such equipment for details.

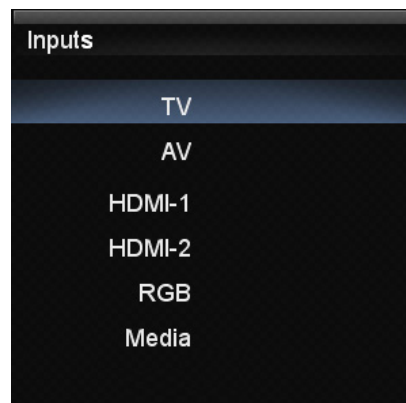

### Watching a TV Program

Before you start watching TV, make sure that any cable, satellite or off-air antenna connections are secure. Also, verify that the AC/DC power adapter is plugged into a correctly grounded electrical outlet or surge protector.

1. Press the power button on the remote control. The VIZIO logo on the front will light up white.
2. Select the input to which your device is connected that provides TV programming (i.e. TV, HDMI, COMP/AV).

**Note:** You should be able to see a picture. If you do not, make sure that all of your HDTV connections are secure and you have selected the correct video input source. Each press of the **INPUT** button on the remote control will cycle through the available inputs. Press the button until the input associated with the device you want to view is shown.

Remember, when using the TV input, the channel buttons will not work until you have performed a channel scan.

3. When using the TV input, press the channel buttons on the remote control or the TV to change the channel. The channel buttons will not work if you are watching a program using HDMI or COMP/AV inputs.

## Viewing Digital TV Program Information

When the channel is changed or when you press the **GUIDE** button, an information header is shown over the picture for a few seconds. Each press of the **GUIDE** button will display more information about the program:





Time Warp: Mouse Trap			Ch 50-123	KCAL DTV	CABLE
11:00 AM - 12:00 AM	TV-PG (V)	CC-OFF	ENGLISH	DOLBY 5.1	720p HD
In this hour-long special, the Time Warp team runs off to join the circus with trap-testing Rev. Tommy Gunn and with high-flying Cirque du Soleil, explore their inner stuntmen, and put everything but wood in a chipper.					



## Chapter 6 Connecting Equipment

### Which Video Connection Should I Use?

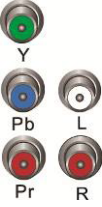
You have several options for connecting your video equipment box to your HDTV from a basic connection to the most advanced for digital displays. Based on your Home Theater configuration, you can decide which option is the right one for you.

Connection Quality (type)	Connector	Description
Best (digital)	 HDMI	<b>HDMI</b> delivers the best image quality of any of the cable types available and it's all done over one cable. You get a great picture and cut down on your cable clutter. HDMI provides digital quality and amazing sound so if your TV has HDMI, this is the connection type you should be using.
Best (digital) ----- Good (analog)		Connect your <b>antenna</b> or <b>coaxial</b> cable to watch TV programming. This cable usually comes from your Cable box or right out of the wall.
Best (analog)	 VGA	The <b>RGB (VGA)</b> port allows you to connect your computer so you can use your HDTV as your monitor.
Better (analog)	 Y Pb L Pr R	<b>Component</b> consists of three cables for transmitting video and two cables for transmitting audio: one red and one white. Component video provides a sharper image than Composite video and should be used instead of Composite when possible. However, because it is still an analog connection, it won't provide the high-quality video and audio that HDMI can produce.
Good (analog)	 VIDEO L R	<b>Composite</b> consists of one yellow cable for transmitting video and two cables for transmitting audio: one red and one white. It is capable of transmitting stereo sound and standard definition video (480i). While it provides a good image, it has lower image quality than HDMI or Component. So try to use one of those connections first. <b>Note:</b> When using an AV (composite) connection, the yellow cable needs to be connected to the green jack on the side of your HDTV.

**Note:** To maintain the display quality, use a VIZIO certified HDMI cable. This cable is available in 6, 8, and 12 foot lengths. Visit [www.vizio.com](http://www.vizio.com) or call 1-888-VIZIOCE (1-888-849-4623) for details.

## Connecting Your Cable or Satellite Box

### Using HDMI (Best)

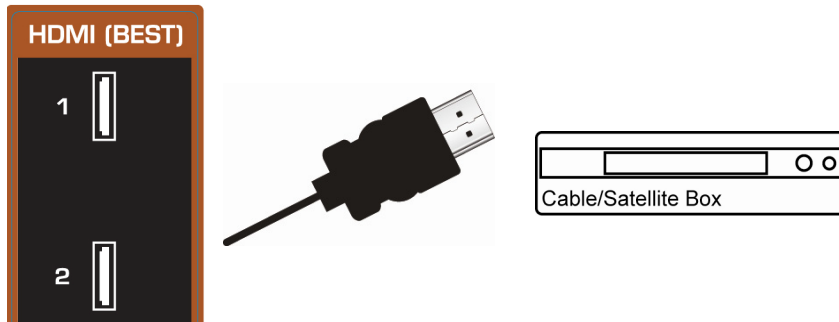

Cable and Satellite Boxes that have a HDMI digital interface should be connected using HDMI for optimal results. To maintain image quality, use a VIZIO certified HDMI cable. This cable is available in 6, 15, and 30 foot lengths. Visit [www.VIZIO.com](http://www.VIZIO.com) or call **877-MYVIZIO** (877-698-4946) for details.

1. Turn off your HDTV and Cable/Satellite box.
2. Connect an HDMI cable to the **HDMI** output of your Cable/Satellite box and the other end to the **HDMI 1** or **2** jack on your HDTV.
3. Turn on the power to your HDTV and your Cable/Satellite box.
4. Select **HDMI-1** or **HDMI-2** using the **INPUT** button on the remote control or side of the TV.

**Note:**

- The HDMI input on your HDTV supports High-bandwidth Digital Content Protection (HDCP). HDCP encrypts the transmission between the video source and the digital display for added security and protection.
- Refer to your Cable/Satellite Set Top Box user manual for more information about the video output requirements of the product or consult your Cable or Satellite operator.

## HDMI Connections for Cable or Satellite Boxes with DVI

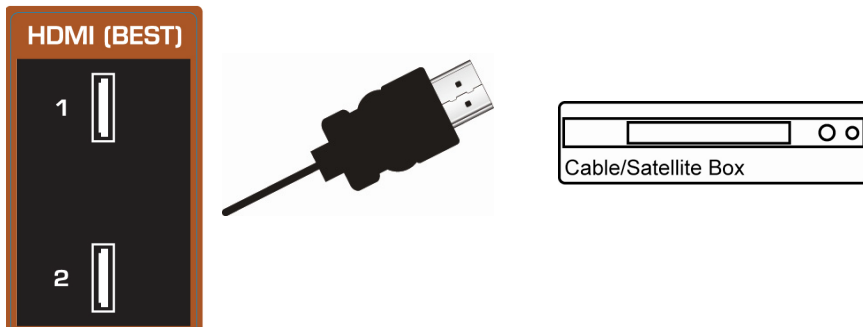

1. Turn off your HDTV and Cable/Satellite box.
2. Using a HDMI-DVI cable, connect the DVI end to your Cable/Satellite box and the HDMI end to the **HDMI 1** or **2** jack on your HDTV.
3. Turn on the power to your HDTV and your Cable/Satellite box.
4. Select **HDMI-1** or **HDMI-2** using the **INPUT** button on the remote control or side of the TV.

**Note:** There are no dedicated audio ports for HDMI so there may or may not be audio from the TV with this connection.

## Using Composite (AV) Video (Good)

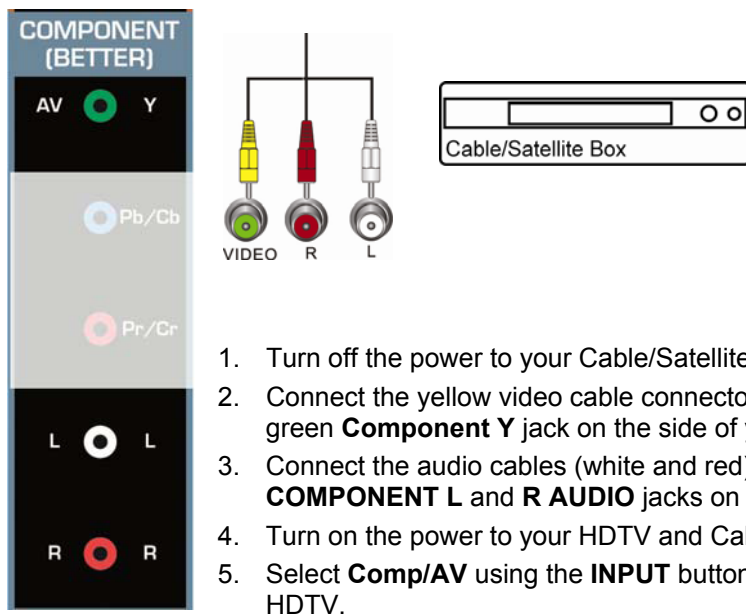

1. Turn off the power to your Cable/Satellite box.
2. Connect the yellow video cable connector from your Cable/Satellite box to the green **Component Y** jack on the side of your HDTV.
3. Connect the audio cables (white and red) from your Cable/Satellite box to the **COMPONENT L** and **R AUDIO** jacks on your HDTV.
4. Turn on the power to your HDTV and Cable/Satellite box.
5. Select **Comp/AV** using the **INPUT** button on the remote control or side of your HDTV.

### Using Coaxial (Antenna) (Good)

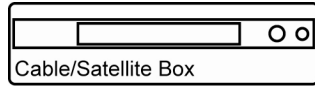

COAXIAL

1. Turn off the power to your HDTV.
2. Connect the coaxial (RF) connector from your antenna or digital cable to the **DTV/TV CABLE/ANTENNA** connector on your HDTV.
3. Turn on the power to your HDTV.
4. Select **TV** using the **INPUT** button on the remote control or side of the TV.
5. Search for new channels. See *Auto Channel Search* on page 36 for more information on scanning for channels.

### Connecting Your DVD Player

#### Using HDMI (Best)

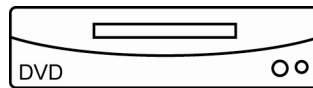
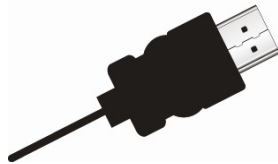
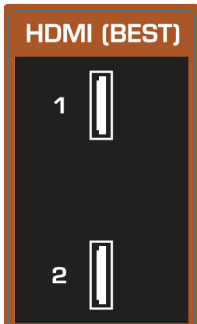

DVD players that have a HDMI digital interface should be connected using HDMI for optimal results. To maintain image quality, use a VIZIO certified HDMI cable. This cable is available in 6, 15, and 30 foot lengths. Visit [www.VIZIO.com](http://www.VIZIO.com) or call **877-MYVIZIO** (877-698-4946) for details.

1. Turn off your HDTV and DVD player.
2. Connect a HDMI cable to the HDMI output of your DVD player and the other end to the **HDMI 1 or 2** jack on your HDTV.
3. Turn on the power to your HDTV and your DVD player.
4. Select **HDMI-1 or HDMI-2** using the **INPUT** button on the remote control or side of the TV.

**Note:**

- The HDMI input on your HDTV supports High-bandwidth Digital Content Protection (HDCP). HDCP encrypts the transmission between the video source and the digital display for added security and protection.
- Refer to your DVD player user manual for more information about the video output requirements.

### HDMI Connections for DVD Players with DVI

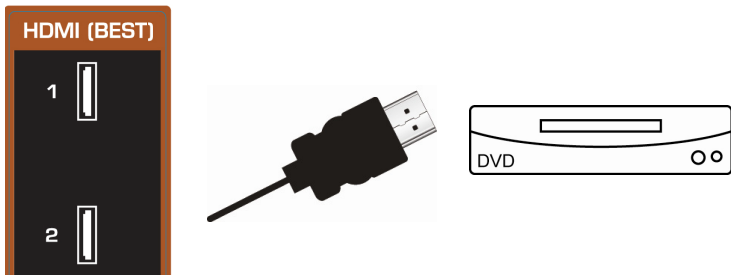

1. Turn off your HDTV and DVD player.
2. Using a HDMI-DVI cable, connect the DVI end to your DVD player and the HDMI end to the **HDMI 1 or 2** jack on your HDTV.
3. Turn on the power to your HDTV and your DVD player.
4. Select **HDMI-1 or HDMI-2** using the **INPUT** button on the remote control or side of the TV.

**Note:** There are no dedicated audio ports for HDMI so there may or may not be audio from the TV with this connection.

### Using Component Video (Better)

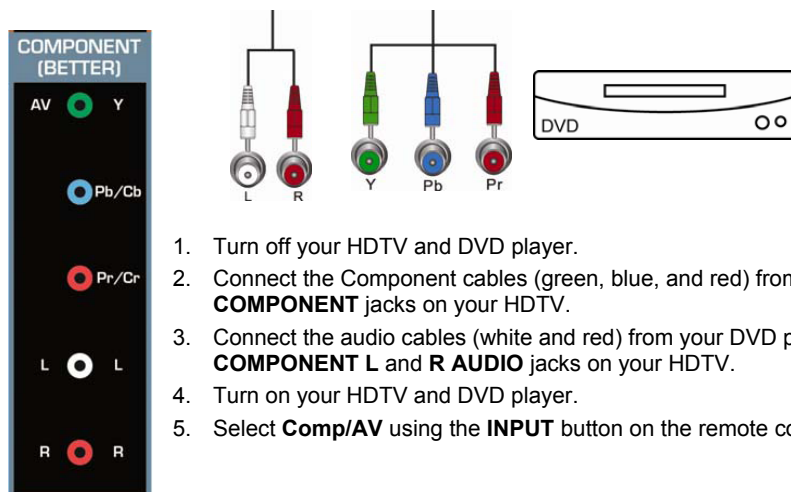

1. Turn off your HDTV and DVD player.
2. Connect the Component cables (green, blue, and red) from your DVD player to the **COMPONENT** jacks on your HDTV.
3. Connect the audio cables (white and red) from your DVD player to the **COMPONENT L and R AUDIO** jacks on your HDTV.
4. Turn on your HDTV and DVD player.
5. Select **Comp/AV** using the **INPUT** button on the remote control or side of your HDTV.

### Using Composite (AV) Video (Good)

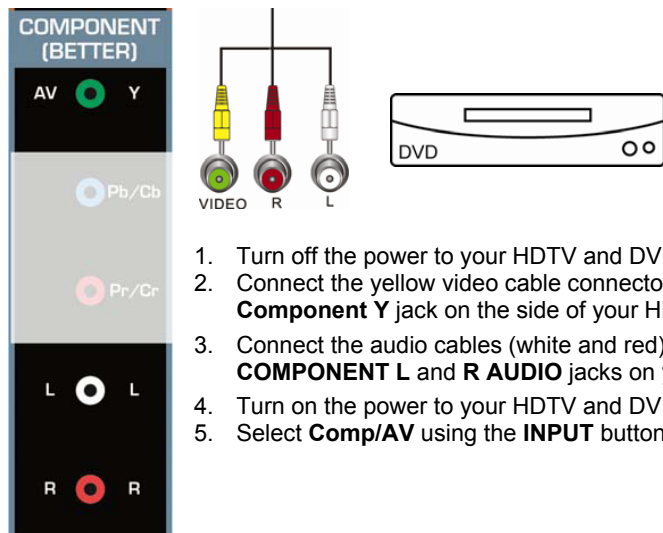

1. Turn off the power to your HDTV and DVD player.
2. Connect the yellow video cable connector from your DVD player to the green **Component Y** jack on the side of your HDTV.
3. Connect the audio cables (white and red) from your DVD player to the **COMPONENT L and R AUDIO** jacks on your HDTV.
4. Turn on the power to your HDTV and DVD player.
5. Select **Comp/AV** using the **INPUT** button on the remote or side of your HDTV.



## Connecting Coaxial (RF)

Using Your Antenna or Digital Cable for Standard or Digital TV

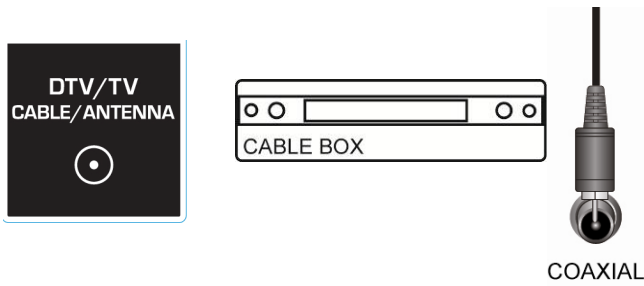

1. Turn off the power to your HDTV.
2. Connect the coaxial (RF) connector from your antenna or cable to the **DTV/TV CABLE/ANTENNA** connector on your HDTV.
3. Turn on the power to your HDTV.
4. Select **TV** using the **INPUT** button on the remote control or side of the TV.
5. Search for new channels. See Channel Search instruction on page 36 for more information on scanning for channels.

## Connecting Your VCR or Video Camera

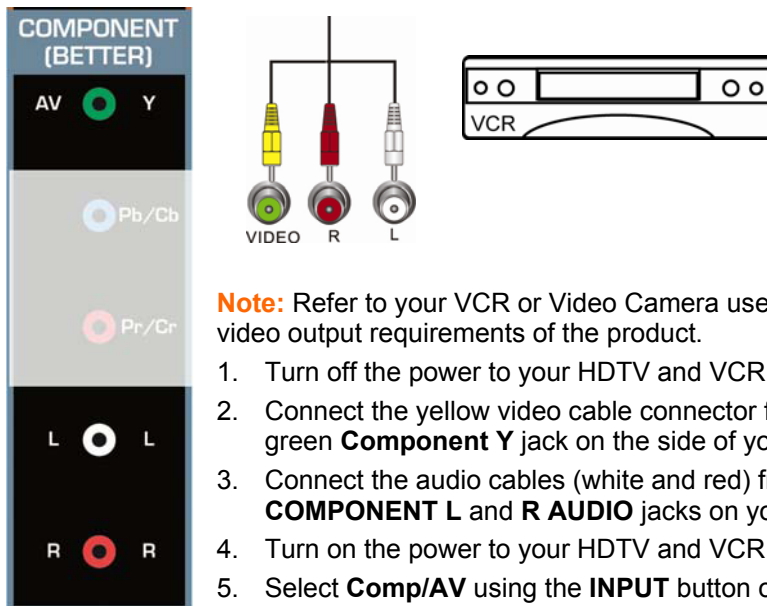

**Note:** Refer to your VCR or Video Camera user manual for more information about the video output requirements of the product.

1. Turn off the power to your HDTV and VCR or video camera.
2. Connect the yellow video cable connector from your VCR or video camera to the green **Component Y** jack on the side of your HDTV.
3. Connect the audio cables (white and red) from your VCR or video camera to the **COMPONENT L** and **R AUDIO** jacks on your HDTV.
4. Turn on the power to your HDTV and VCR or video camera.
5. Select **Comp/AV** using the **INPUT** button on the remote control or side of your HDTV.

## Connecting a Home Theater System

### Using Optical (S/PDIF)

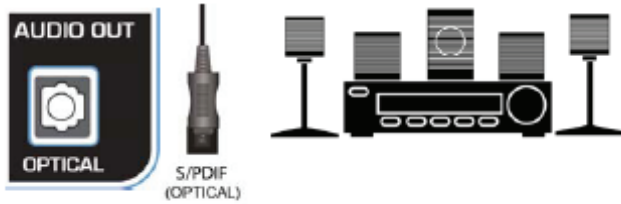

If your sound system has a S/PDIF (optical) digital audio input you can connect it from your sound system to the **OPTICAL** digital audio out on your HDTV. This is active when receiving audio with the programs being viewed no matter what input is being used.

1. Connect one end of the optical cable to optical connectors on the Home Theater and the other end to the **OPTICAL** jack on your HDTV.
2. Turn on the power to your HDTV and home theater.
3. Change the input on your Home Theater to optical. See your Home Theater user manual for more information.

## Connecting a Computer

### RGB (VGA)

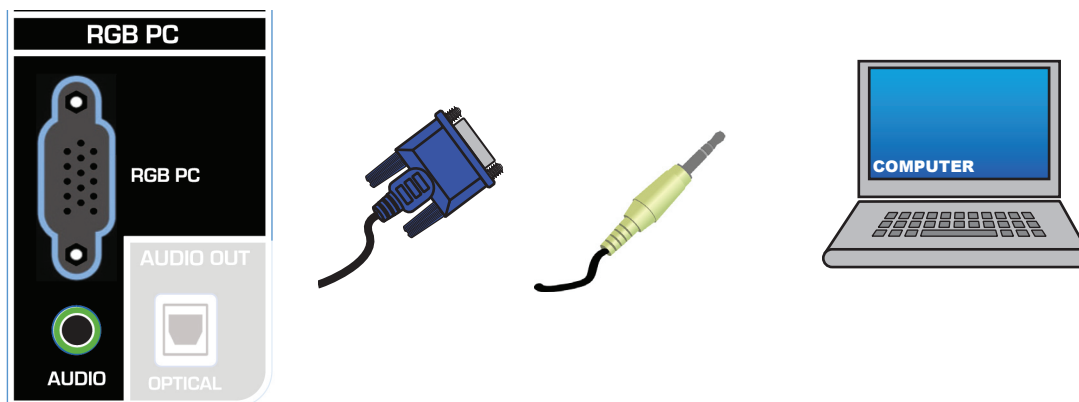

1. Set computer to a resolution supported by your HDTV (see *Preset PC Resolutions* on page 49). If your computer supports it, we recommend 1920x1080.
2. Turn off the power to your HDTV and computer.
3. Connect the RGB (VGA) cable from your computer to the **RGB PC** jack on of your HDTV.
4. Connect the 1/8-inch audio cable from your computer to the **RGB PC Audio** jack on your HDTV. This step is optional and only needed if you want to transmit audio from the computer through the TV.
5. Turn on the power to your HDTV and computer.
6. Select **RGB (VGA)** using the **INPUT** button on the remote control or side of the TV.

**Note:** Refer to your PC computer user manual for more information about the video output requirements.

## Using HDMI

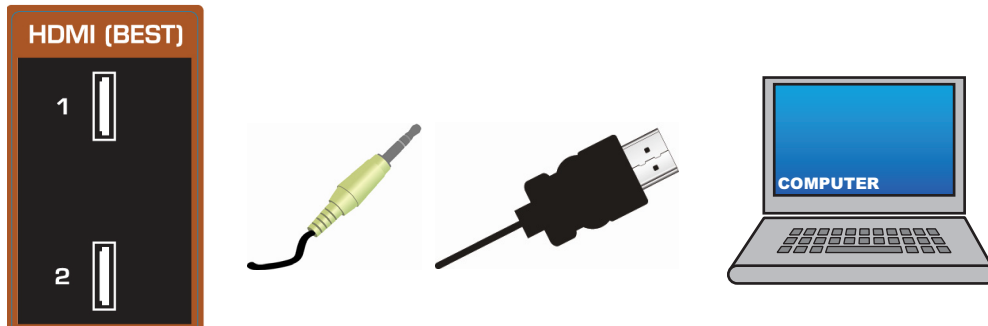

1. Turn off your HDTV and computer.
2. Connect a HDMI cable to the HDMI output of your computer and the other end to the **HDMI 1 or 2**, jack on your HDTV.
3. Connect the 1/8-inch audio cable from your computer to the **RGB PC Audio** jack on your HDTV. This step is optional and only needed if you want to transmit audio from the computer through the TV.
4. Turn on the power to your HDTV and your computer.
5. Select **HDMI-1 or HDMI-2** using the **INPUT** button on the remote control or side of the TV.

## Chapter 7 Viewing Pictures

Connect a USB flash drive to the USB port on your HDTV to view pictures.

- USB drives that are USB 2.0 and FAT or FAT32 are supported. The USB Port does not support external hard drives or USB hubs.
- If your USB drive is oversized and does not physically fit in the USB port, use a USB extension cable. Connect one end of the cable to your USB drive and the other end to the USB port.
- Supported file extensions include .jpg and .jpeg.

**Note:** Even the supported format files listed above may or may not play properly or completely, depending on the USB device, bit rate stream, and other content characteristics, as well as other factors.

### Viewing Pictures

1. Insert a USB device with digital content such as photos, music, and movies into the Multimedia port on the side of your HDTV. If a USB device is already connected, press **MENU** on the remote control and select *Media*. A message will appear asking if you want to play multimedia content.
2. Press ◀ or ▶ to highlight **OK**, and then press **OK** to select it. The *Picture* folder will be displayed.
3. Press **OK** to select it. A menu will be displayed showing the folders and files that are on your USB device.
4. Press ◀ or ▶ to highlight the folder or file you want to play, and then press **OK** to select it. The file will play. See *Adjusting Photo Settings* on page 29 below to adjust various settings including setting up a slideshow and setting picture duration.
5. When finished, press **EXIT** once to return to the previous screen or repeatedly to return to the main menu.

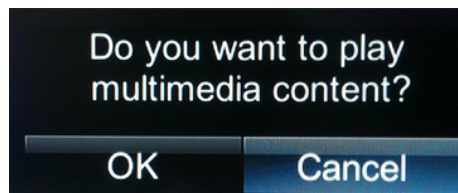

## Adjusting Photo Settings

When viewing pictures you can adjust various settings, including slideshow, picture duration, etc.

1. Insert a USB device containing pictures and select the folder or files that you want to play.
2. Press **MENU**. The Picture menu will be displayed.
3. Press **▲** or **▼** on the remote control to highlight a Picture menu option, and then press **◀** or **▶** to adjust the setting.
4. Press **MENU** once to close the menu.

### Slideshow Mode

Choose from **Shuffle**, **Single**, and **Sequence** to set the slideshow mode. Press **OK** to begin the slideshow. Press **OK** to stop the slideshow.

- **Single** will display one picture selected from the thumbnails for the interval set in the *Duration* option and return to the thumbnails. If the *Repeat* option is set to **On**, the selected picture will be displayed until you press **EXIT**.
- **Sequence** will show your pictures in the order they are listed on your USB device until you stop the slideshow.
- **Shuffle** will show your pictures in random order until you stop the slideshow.

### Repeat

Choose from **On** or **Off** to repeat the slideshow.

### Sort By

You can choose to sort the pictures on the USB device by **Photo Date**, **File Date**, or alphabetically (**File A-Z**).

### Duration

Set the amount of time the picture will remain on the screen during the slideshow. Choose a time between 5 seconds and 32 seconds.

### Slideshow Effect

Choose from **Random**, **Dissolve**, **Wipe Right**, **Wipe Left**, **Wipe Up**, **Wipe Down**, **Box In**, or **Box Out** to set the transition type when changing from one picture to another during a slideshow.

### Thumbnail Size

Set the size of the preview pictures (thumbnails) in the menu. Choose from **Small**, **Medium**, or **Large**.

### Info

When set to **On**, information about the picture briefly appears on your HDTV.

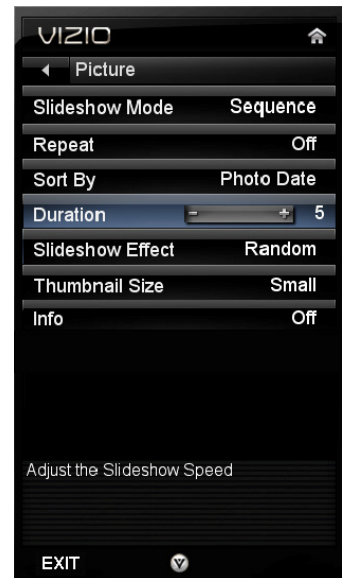

## Chapter 8 Adjusting Your HDTV Settings

### Using the On-screen Display (OSD)

The remote control or the control buttons on the side of the TV can control all the function settings. The *OSD* allows you to adjust contrast, brightness and other settings. The TV will save changes made to the settings, even if the TV is turned off.

The OSD consists of several menu options. The main menu options may vary depending on your selected input source.

**Note:** Some of the main menu options may have additional submenus, for example, the TV Rating submenu for Parental Controls.

1. Press **MENU**. The *OSD* opens.
2. Press **◀**, **▶**, **▲**, or **▼** on the remote control to select one of the menu options:
  - Input
  - Wide
  - CC
  - Sleep Timer
  - Picture
  - Audio
  - Settings
  - Media
  - Help
3. Press **OK** to select the option or feature you want to adjust.
4. After the menu option is displayed, press **▲** or **▼** on the remote control to select one of the items to adjust.
5. Press **OK** to select it, and then press **◀**, **▶**, **▲**, or **▼** to adjust the selection.
6. Press **BACK** once to return to the previous screen. To return to your program once adjustments have been completed, press the **EXIT** button on the remote control.

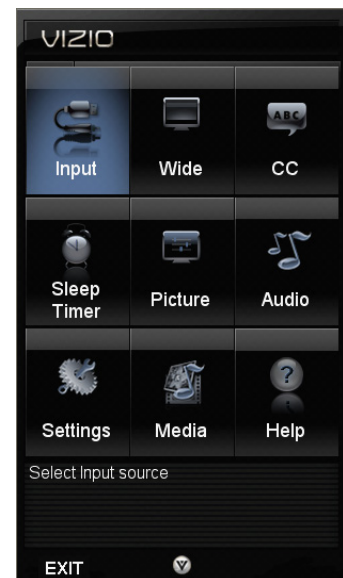

### Input Menu

Select the Input Source for your HDTV.

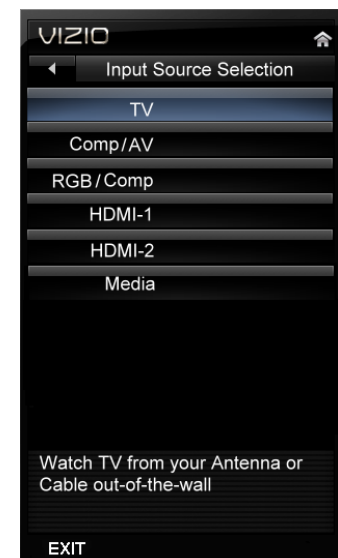

## Wide Menu

Select how the picture displays on the screen. As you select an option, you will see the screen adjusting to the different sizes. The options vary depending on the selected input and the TV program:

### Normal

The original 4:3 aspect ratio (1.33:1 source) is preserved, so black bars are added to the left and right of the display image. Standard TV broadcasts are displayed with a 4:3 Aspect Ratio. Movies in 4:3 Aspect Ratio may be referred to as pan-and-scan or full frame. These movies were originally filmed in 16:9 (widescreen), and then modified to fit a traditional TV screen (4:3).

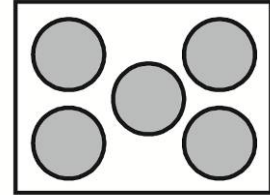

### Wide

Wide mode allows you to view the entire picture. Recommended for HDMI and RGB / Computer viewing so you can see the complete picture without the image overstretching beyond the viewing area. If you experience “noise” along the border switch to Zoom 1. For 720p, 1080i, 1080p only.

### Panoramic

When watching a standard broadcast or full frame movie in this mode, the 4:3 Aspect Ratio (1.33:1 source) display image is stretched horizontally on the left and right sides to fill the TV screen. The center of the image is not stretched.

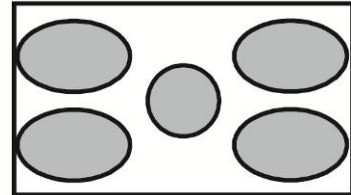

### Stretch

When watching a widescreen program (1.78:1 source) with black bars on the sides, the display image will stretch to fill the TV screen. People will appear wider than they really are. If you are watching a widescreen (1.85:1 or 2.35:1 source) program or movie, there will still be black bars at the top and bottom. This mode is available only when watching a widescreen program.

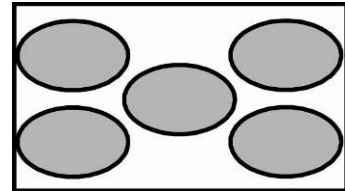

## CC (Closed Caption) Menu

Adjust closed caption options.

### Analog Closed Caption

The CC feature is available when watching regular analog TV. Select from **Off**, **CC1**, **CC2**, **CC3**, and **CC4**. Closed Caption for regular TV is usually **CC1** or **CC2**.

### Digital Closed Caption

The CC feature is available when watching digital TV. Select from **CC1**, **CC2**, **CC3**, **CC4**, or **CS1**, **CS2**, **CS3**, **CS4**, **CS5**, **CS6**, or **Off**.

### Digital CC Style

The Digital CC Style feature is available when watching digital TV.

- **Caption Style:** Select either **As Broadcaster** or **Custom**. If Custom is selected you can customize the way Closed Caption is displayed. The options available are:
  - **Text Size:** Make CC text larger or smaller.
  - **Color:** Choose a text color for CC display
  - **Opacity:** Make text more or less transparent.
  - **BG Color:** Choose a background color for CC text.
  - **BG Opacity:** Make the background for CC text more or less transparent.
  - **Window Color:** Choose a text frame color for CC text.
  - **Window Opacity:** Make the text frame for CC text more or less transparent.

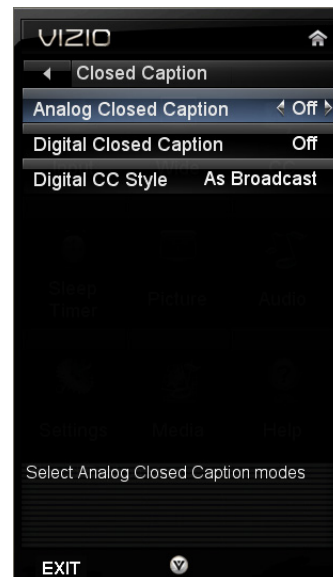

## Sleep Timer Menu

Select the timer to turn off the TV in **30**, **60**, **90**, **120** or **180** minutes.

## Picture Menu

Adjust picture options including brightness, contrast, and advanced picture settings.

### Picture Mode

Choose from **Standard**, **Movie**, **Game**, **Vivid**, or **Custom**. Each input (i.e. HDMI, COMP, etc) remembers the custom setting you created. Select **Custom** to manually adjust *Backlight*, *Brightness*, *Contrast*, *Color*, *Tint*, *Sharpness*, and to access the *More* menu where further adjustments can be made.

### Backlight

Adjust the LED brightness to affect the overall brilliance of the picture not the Brightness (black level) or Contrast (white level) of the picture.

**Note:** Backlight is only available when *Picture Mode* is set to **Custom**.

### Brightness

Adjust black levels in the picture. If the brightness is too low you will not be able to see the detail in darker parts of the picture and if the brightness is too high the picture will look washed out.

**Note:** Brightness is only available when *Picture Mode* is set to **Custom**.

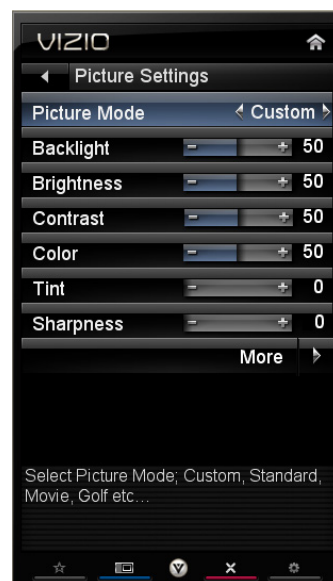



**Contrast**

Adjust the white levels in the picture. If the contrast is too low the picture will look washed out and if the contrast is too high you will not be able to see any detail in the bright parts of a picture.

**Note:** Contrast is only available when *Picture Mode* is set to **Custom**.

**Color**

Adjust the amount of color in the picture.

**Note:** Color is only available when *Picture Mode* is set to **Custom**.

**Tint**

Adjust the hue of the picture. The easiest way to set tint is to look at flesh tones and adjust for a realistic appearance. In most cases, the default middle position is correct. If people’s faces look too orange try reducing the level of color first.

**Note:** Tint is only available when *Picture Mode* is set to **Custom**.

**Sharpness**

Adjust the sharpness of the edges of elements in the picture. It does not produce detail that otherwise does not exist. This adjustment is helpful when viewing Standard Definition sources.

**Note:** Sharpness is only available when *Picture Mode* is set to **Custom**.

**More**

Select **More** to adjust advanced options for fine tuning the picture.

**Note:** The *More* menu is only available when *Picture Mode* is set to **Custom**.

**Size & Position**

To select the options in the Size & Position sub-menu, press the **MENU** button or the ► button. A new menu will be displayed showing the following Size & Position settings:

- **Horiz. Position**  
Adjust the horizontal position of the picture.
- **Vertical Position**  
Adjust the vertical position of the picture.
- **Horizontal Size**  
Adjust the horizontal size of the picture.
- **Vertical Size**  
Adjust the vertical size of the picture.

**Note:** The Size & Position function is only available in HDMI or RGB modes.

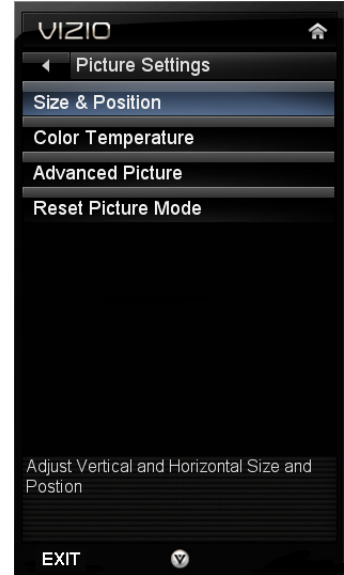

## Color Temperature

Color Temperature is the “warmness” or “coolness” of the white areas of the picture. Choose from **Custom**, **Cool**, **Normal**, or **PC**. **Normal** is the setting for television broadcasting. **Custom** allows you to set a preset calibrated for a white point to suit individual preferences. **Cool** produces a blue-hued image. **PC** sets the white point at the established setting for a computer display (9300K). Each preset may also be adjusted for a customized setting.

## Advanced Picture

To select the options in the Advanced Picture sub-menu, press **OK**. A new menu will be displayed showing the advanced functions available for fine tuning of the picture.

- **Noise Reduction**

This feature diminishes picture artifacts caused by the digitizing of image motion content that may be present in the picture. Choose from **Off**, **Low**, **Medium**, or **High**.

- **Color Enhancement**

This feature increases the picture reproduction performance of the picture by reducing oversaturation of certain colors and improving flesh tones. Choose from **Off**, **Normal**, **Rich Color**, **Green/Flesh**, and **Green/Blue**.

- **Adaptive Luma**

Large areas of brightness in the picture will result in a higher Average Picture Level (APL) and the overall picture will look too light. This feature will lower the APL to counteract this effect. Choose from **Off**, **Low**, **Medium**, **Strong**, or **Extend**.

- **Film Mode**

Choose from **Off** or **Auto**. When set to **Off** it will stay at 60 fps. When set to **Auto**, the TV will detect the cadence (for example at 24 frames/second for film, or normal video at 60 fps).

- **Backlight Control**

Set this feature to **OFF**, **DCR**, or **OPC**. **DCR** (Dynamic Contrast Ratio) improves the black level performance and increases contrast ratio. **OPC** (Optimum Power Control) Reduces power consumption while maintaining the same picture brightness.

- **Ambient Light Sensor**

Choose **Off**, **Low**, **Medium**, or **High**. When set to on, your HDTV will automatically adjust to light changes in the room.

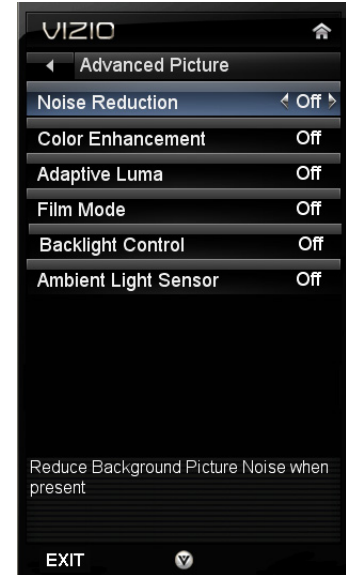

## Reset Picture Mode

Return all Picture settings to factory default. A screen will come up to confirm your selection or to cancel it. Press **◀** or **▶** to make the selection, and then press **OK** to accept it.

**Note:** Only settings under the Picture will be reset.

## Audio Menu

Adjust audio options including balance, equalizer, and advanced audio settings.

### Audio Mode

Choose from Flat, Rock, Pop, Classic or Jazz.

### Balance

Adjust the sound to the left or the right.

### Lip Sync

Lip Sync is designed to adjust the audio of the program being viewed so that it matches the movement of the lips of someone talking on the screen.

### TV Speakers

Turn the internal speakers On or Off. You may want to turn the internal speakers off when listening to the audio through your Home Theater System.

### Advanced Audio

To select the options in the Advanced Audio sub-menu, press ►. A new menu will be displayed showing the advanced functions available for fine tuning of the audio.

#### SRS TruSurround HD™

This option sets the SRS True Surround HD™ surround sound process. Choose from On or Off.

**Note:** When SRS TruSurround HD™ is ON, Equalizer adjustments are not available.

#### SRS TruVolume

When the programming switches to a commercial or when changing from channel to channel, volume fluctuations occur. When turned ON, SRS TruVolume™ provides the listener with a comfortable and consistent volume level. Turn this option Off when listening to music.

#### Digital Audio Out

This option allows selection of the type of processing for the S/PDIF (Optical connector) when used with a Receiver/Amplifier/Home Theater system. Select to choose from OFF, Dolby Digital or PCM.

#### Analog Audio Out

This option sets the volume control properties when using the RCA (white and red) connectors as audio line out to connect a Receiver/Amplifier/Home Theater system. Choose from Fixed or Variable. When set to Variable, volume from the external speakers will change according to the volume setting on the TV. If it is set to Fixed, the volume can only be changed by the settings on the external stereo system.

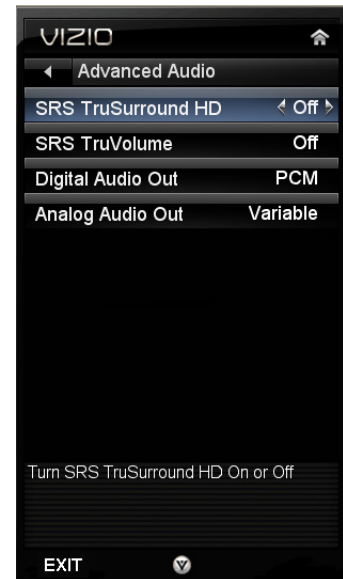
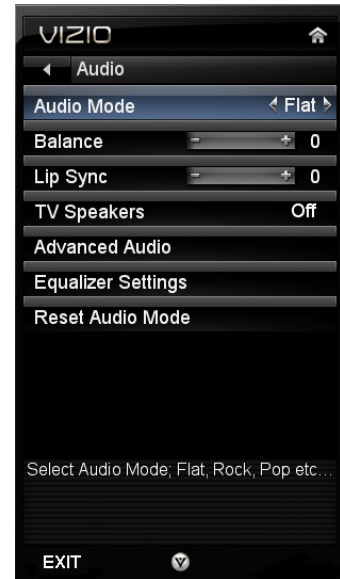

## Equalizer Settings

To select the options in the Equalizer sub-menu, press **OK**. A new menu will be displayed showing the volumes of different frequencies.

Starting from lowest to the highest, they are 120Hz, 500Hz, 1.5kHz, 5kHz and 10kHz.

1. Press ◀ or ▶ to select the frequency to be adjusted.
2. Use ▲ or ▼ to adjust the selected frequency to your preference. Values above 0 will boost the frequency and values below 0 will attenuate the frequency.

**Note:** The Equalizer adjustment will only be available when SRS TSHD is set to Off.

## Reset Audio Mode

Return all Audio settings to factory default. A screen will come up to confirm your selection or to cancel it. Press ◀ or ▶ to make the selection, and then press **OK** to accept it.

**Note:** Only settings under the Audio menu will be reset.

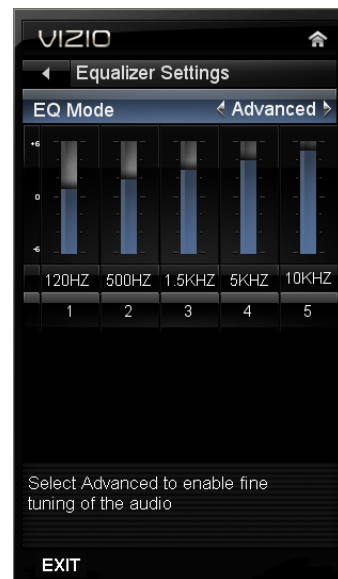

## Settings Menu

### Tuner

**Note:** The tuner option can only be selected when your HDTV is in TV input mode.

#### Tuner Mode

Select Cable or Antenna depending upon which you have attached to the DTV / TV Input.

#### Auto Channel Search

Automatically search for TV channels that are available in your area. Be sure to first select the correct tuner mode above. The TV will search for analog and digital channels. When the search is done, press **OK** to begin watching your programs.

#### Partial Channel Search

If you believe channels are missed from the auto search, you can do a partial channel search to look for channel in a certain channel range again. Select to scan for Analog, Digital, or both Analog/Digital channels, then press the ▼ button to highlight the “From” and “To” selection. Press the ▶ button to select the range of channel numbers you want to start searching in. Press **OK** to start channel search.

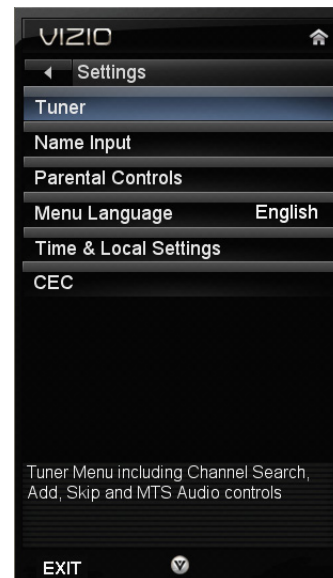

### Skip Channel

After the TV has stored all of the available digital channels in memory you will find that some channels are too weak to watch comfortably or they may be channels you do not want to see. Press **OK** to select the channel to be skipped when using the CH+ or CH- button. An X will appear in channels you have selected to skip. You will still be able to select this channel using the number buttons on the remote control.

### MTS

This feature allows you to select the different languages the broadcaster is transmitting the audio with the program you are watching. This signal is usually Spanish. Choose from **Mono**, **Stereo**, or **SAP**.

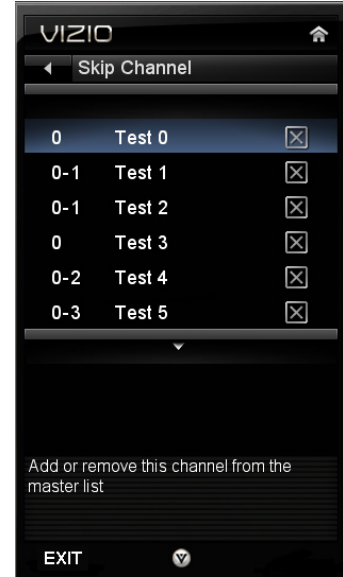

### Name Input

This feature makes it easier for you to recognize the devices you have connected to your HDTV when you press **INPUT**. For example, if you have a Blu-Ray DVD player connected to the HDMI-1 input, you can have the input label read *HDMI-1 BluRay* instead of just *HDMI-1*. You can select from 10 preset labels.

#### To use one of the 10 preset labels:

1. Select *Input Source*, and then press **OK** to show the list of inputs.
2. Press **▼** to select the input label you want to change, and then press **OK**.
3. Press **▼** to select *Input Labels*, and then press **OK** to show the list of 10 preset labels.
4. Press **▼** to select the new input label name, and then press **OK**.

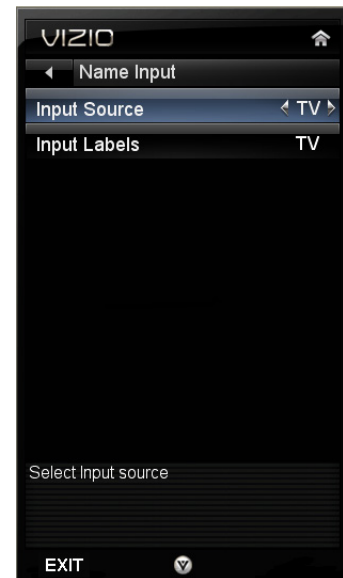

## Parental Controls

If you want to restrict certain channel and program viewing, you can do this by turning on the Parental Control. Selected programs, movies and channels can then be made available only after an authorized password has been entered and accepted by the TV.

**Note:** The Parental Controls are divided into **LOCK** and **UNLOCK** menus. To activate or lock parental controls, use the **LOCK** menu. To deactivate or unlock parental controls, use the **UNLOCK** menu.

### Navigating Lock and Unlock Menus

To access or navigate the **LOCK** menu, you must use the **Channel Up/Down** and **INPUT** buttons on the side of the TV. **The remote control buttons do not control the LOCK menu.**

To access or navigate the **UNLOCK** menu, you can use the **Arrow** and **OK** buttons on the remote. Enter your PIN when prompted.

### Lock and Unlock Menu Functions

#### Rating Enable

Select **ON** or **OFF**. If set to **OFF**, you will not be able to set the US TV, US Movie, Canadian English, or Canadian French Ratings.

#### Channel Locks

Block individual channels from being displayed.

#### USA-TV

**Note:** When Rating Enable is **OFF**, the USA-TV Rating adjustments are not available.

- TV-Y** – All children
- TV-Y7** – Older children
- TV-G** – General audience
- TV-PG** – Guidance suggested
- TV-14** – Strongly cautioned
- TV-MA** – Mature audience

You can also customize the TV ratings for the following content:

- A** – All sub-ratings
- FV** – Fantasy violence
- D** – Sexual dialog
- L** – Adult language
- S** – Sexual situations
- V** – Violence

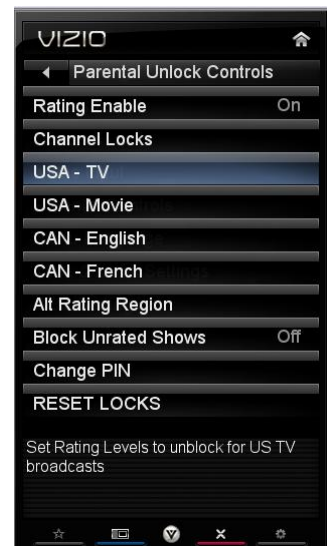
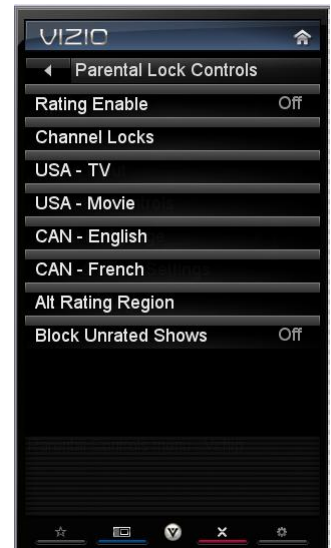

### **USA-Movie**

**Note:** When Rating Enable is **OFF**, USA-Movie Rating adjustments are not available.

**G** – General audience

**PG** – Parental guidance suggested

**PG-13** – Recommended for children 13 years of age or older

**R** – Mature audience

**NC-17** – No one under 17 years of age

**X** – No one under 17 years of age

### **CAN-English**

**Note:** When Rating Enable is **OFF**, Canadian English Rating adjustments are not available.

**C** – Children

**C8+** – Children 8 years or older

**G** – General Programming, suitable for all audiences

**PG** – Parental guidance

**14+** – Viewers 14 years or older

**18+** – Adult programming

### **CAN-French**

**Note:** When Rating Enable is **OFF**, Canadian French Rating adjustments are not available.

**G** – General audience

**8 ans+** – General – not recommended for young children

**13 ans+** – Not suitable for children under 13 years of age

**16 ans+** – Not suitable for under 16 years of age

**18 ans+** – Adults only

### **Alt Rating Region**

This setting is not used. It is reserved for future rating systems.

### **Block Unrated TV**

Block programming that does not have a rating.

### **Change PIN (UNLOCK Menu Only)**

Enter a new, 4-digit password using the number buttons on the remote control. Enter it a second time to confirm you entered it correctly.

**Note:** Make sure you write down and store the new password in a secure place. The *Reset Locks* feature does NOT reset the password.

### **RESET LOCKS (UNLOCK Menu Only)**

Return all Parental Control lock settings to factory default. A screen will come up to confirm your selection or to cancel it. Press ◀ or ▶ to make the selection, and then press **OK** to accept it.

## Menu Language

Select to change the language of the menu. The default is **English**. You can also select **French** or **Spanish**.

## Time & Local Settings

### Time Zone

Setting the correct Time Zone for your area will ensure that the correct time is shown after pressing the **GUIDE**

### Daylight Saving

button on the remote control. Setting the daylight saving time for your area will ensure that the correct time is shown after pressing the **GUIDE** button on the remote control.

## CEC

Consumer Electronics Control allows you to control other devices using your HDTV remote control when those devices are connected via HDMI. For example, if a CEC-supported Blu-ray DVD player is connected to your HDTV through HDMI-2 and that player is powered on, your HDTV will automatically change to the HDMI-2 input. Similarly, if your HDTV is powered on first and you change the input to HDMI-2, your Blu-ray player will automatically power on.

Also, you can control your CEC-supported device using the transport keys on your HDTV remote control (e.g. Play, Stop, Prev, etc.). When you press one of the buttons on your HDTV, the action will occur on your device.

Contact your devices' user manual or manufacturer to check whether your device supports CEC.

### CEC Function

Turn CEC On or Off. When set to Off, your HDTV will not send or receive any CEC commands.

### Device Discovery

Register device with TV. Before CEC will work, perform a Device Discovery to see if there are any CEC supported devices connected to your HDTV.

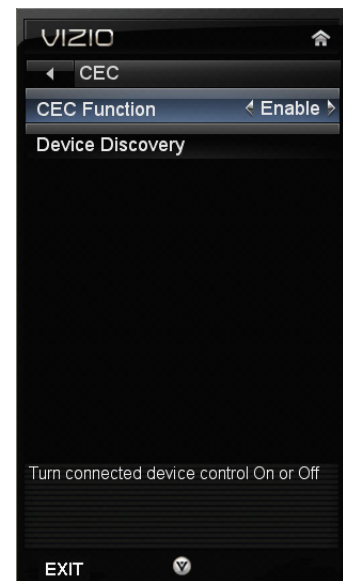



## Media Menu

When viewing pictures you can adjust various settings, including slideshow, picture duration, etc.

1. Insert a USB device containing pictures and select the folder or files that you want to play.
2. Press **MENU**. The Picture menu will be displayed.
3. Press **▲** or **▼** on the remote control to highlight a Picture menu option, and then press **◀** or **▶** to adjust the setting.
4. Press **MENU** once to close the menu.

## Slideshow Mode

Choose from **Shuffle**, **Single**, and **Sequence** to set the slideshow mode. Press **OK** to begin the slideshow. Press **EXIT** to stop the slideshow.

- **Single** will display one picture selected from the thumbnails for the interval set in the *Duration* option and return to the thumbnails. If the *Repeat* option is set to **On**, the selected picture will be displayed until you press **EXIT**.
- **Sequence** will show your pictures in the order they are listed on your USB device until you stop the slideshow.
- **Shuffle** will show your pictures in random order until you stop the slideshow.

## Repeat

Choose from **On** or **Off** to repeat the slideshow.

## Sort By

You can choose to sort the pictures on the USB device by **Photo Date**, **File Date**, or alphabetically (**File A-Z**).

## Duration

Set the amount of time the picture will remain on the screen during the slideshow. Choose a time between 5 seconds and 32 seconds.

## Slideshow Effect

Choose from **Random**, **Dissolve**, **Wipe Right**, **Wipe Left**, **Wipe Up**, **Wipe Down**, **Box In**, or **Box Out** to set the transition type when changing from one picture to another during a slideshow.

## Thumbnail Size

Set the size of the preview pictures (thumbnails) in the menu. Choose from **Small**, **Medium**, or **Large**.

## Info

When set to **On**, information about the picture briefly appears on your HDTV.

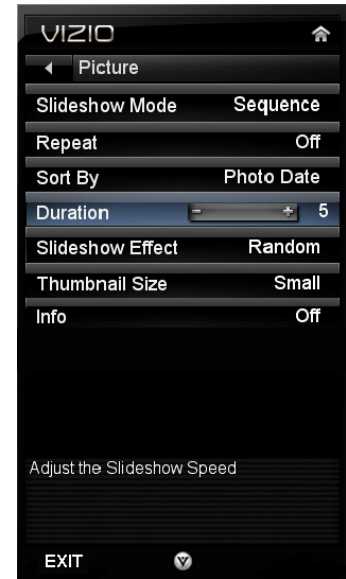

## Help Menu

### System Info

Display the technical information including model name, version and revision of firmware, source type, and resolution.

### Reset TV Settings

Return all Picture and Audio settings to factory default. A screen will come up to confirm your selection or to cancel it. Press Left or Right Navigation buttons to make the selection, and then press **OK** to accept it.

**Note:** This does **NOT** reset the Parental Control Password.

### Clear Memory (Factory Default)

Use this function to reset the TV to the default factory settings. The screen will display a message to confirm that you want to reset the values to factory settings. Press ◀ or ▶ to make the selection, and then press **OK** to accept it.

**Note:** This does **NOT** reset the Parental Control Password.

### Start Setup Wizard

Use this function to return to the Initial Setup menu. Use this function if you want to have a guided setup when you move your TV. Refer to Chapter 3 for more information.

**Note:** Previously scanned channels will be removed.

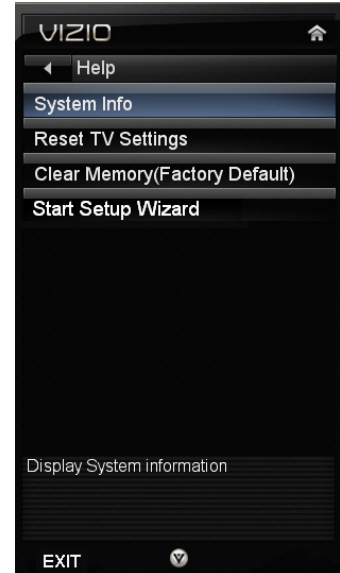

## Chapter 9 Maintenance and Troubleshooting

### Cleaning the TV and Remote Control

1. Remove the power adapter cable from the TV.
2. Use a soft cloth moistened with diluted neutral cleaner to clean the TV and remote control. VIZIO recommends using an HDTV cleaning solution which can be purchased at any major retailer.
3. Wring liquid out of the cloth before cleaning to prevent water from penetrating into the housing.
4. Wipe the TV and remote control with a dry cloth after cleaning.

**Important:**

- Do not use volatile solvent (such as toluene, rosin and alcohol). Such chemicals may damage the housing, screen glass, and remote control, and cause labeling to peel.
- The screen glass is very fragile. Do not scrape it with any sharp object.
- Do not press or tap the screen to avoid cracking.

### Troubleshooting Guide

If the TV fails or the performance changes dramatically, check the following troubleshooting guide for possible solutions. Remember to check the peripherals to pinpoint the source of the failure. If the display still fails to perform as expected, contact the VIZIO for assistance by calling 1-877-MYVIZIO (698-4946) or e-mail us at [techsupport@vizio.com](mailto:techsupport@vizio.com).

General TV Problems	Solution
Receive the error message "No Signal."	<ul style="list-style-type: none"> <li>• Press the INPUT button on the remote control to select a different input source.</li> <li>• If you are using cable connected directly to the TV or an antenna, scan for channels from the Tuner menu in the OSD.</li> <li>• Press the TV button on the top of the remote to return to the TV mode.</li> </ul>
No power.	<ul style="list-style-type: none"> <li>• Make sure the power button is ON (VIZIO logo glows white).</li> <li>• Make sure the AC power cord is securely connected to the AC socket.</li> <li>• Plug another electrical device to the power outlet to verify that the outlet is working.</li> </ul>
No sound.	<ul style="list-style-type: none"> <li>• Press Volume + (Up) on the remote control.</li> <li>• Press MUTE on the remote control to make sure that MUTE is not ON.</li> <li>• Check your audio settings. The audio may be set to SAP, or the speakers are set to off.</li> <li>• Check the audio connections of external devices that may be connected to the HDTV.</li> <li>• If you are using an antenna, the signal strength of the channel may be low. Make sure your antenna is connected securely to the TV and move the antenna around the room or close to a window.</li> </ul>
If the screen is black.	<ul style="list-style-type: none"> <li>• Make sure the power button is ON (VIZIO Logo glows white).</li> <li>• Press the INPUT button on the remote control to select a different input source.</li> <li>• Check the connections of external devices that may be connected to the HDTV.</li> <li>• Press the TV button on the top of the remote to return to the TV mode.</li> </ul>

General TV Problems	Solution
Power is ON but there is no image on the screen.	<ul style="list-style-type: none"> <li>• Make sure all cables attached to the HDTV are connected to the correct output on the external device.</li> <li>• Adjust brightness, contrast or backlight.</li> <li>• Press the INPUT button on the remote control to select a different input source.</li> <li>• Press the TV button on the top of the remote to return to the TV mode.</li> </ul>
Wrong or abnormal colors appear.	<ul style="list-style-type: none"> <li>• Check Color and Tint settings in Picture Menu.</li> <li>• Reset Picture settings.</li> <li>• Check the video cables to make sure they are securely connected.</li> <li>• If you are using an antenna, the signal strength of the channel may be low. Make sure your antenna is connected securely to the TV and move the antenna around the room or close to a window.</li> </ul>
Control buttons do not work.	<ul style="list-style-type: none"> <li>• Press only one button at a time.</li> <li>• Press the TV button on the top of the remote to return to the TV mode.</li> </ul>
Remote control does not work.	<ul style="list-style-type: none"> <li>• Point the remote control directly at the remote sensor on your TV.</li> <li>• Remove any obstacles between the remote control and the remote sensor.</li> <li>• Replace dead batteries with new ones.</li> <li>• Press the TV button on the top of the remote to return to the TV mode.</li> </ul>
There appear to be image quality issues.	<ul style="list-style-type: none"> <li>• If you are using an antenna, the signal strength of the channel may be low. Make sure your antenna is connected securely to the TV and move the antenna around the room or close to a window.</li> <li>• For best image quality, view HD wide-screen programs where possible.</li> <li>• If HD content is not available view "Standard Definition" from a digital source.</li> <li>• Standard, analog TV will always be noticeably inferior to HD because your digital flat panel TV has video that is many times better than old TV so you will see interference and deficiencies you did not know you had.</li> </ul>
You cannot see a picture.	<ul style="list-style-type: none"> <li>• Make sure the power button is ON (VIZIO logo glows white).</li> <li>• Make sure the AC power cord is securely connected to the AC socket.</li> <li>• Press the INPUT button on the remote control to select a different input source.</li> <li>• Press the TV button on the top of the remote to return to the TV mode.</li> <li>• Check the connections of external devices that may be connected to the HDTV.</li> <li>• If your HDTV is connected to a computer, press any button on your keyboard to "wake" your computer.</li> <li>• If you are using an antenna, the signal strength of the channel may be low. Make sure your antenna is connected securely to the TV and move the antenna around the room or close to a window.</li> </ul>
You see a distorted picture or hear unusual sound.	<ul style="list-style-type: none"> <li>• You may be getting interference from electrical appliances, cars, motorcycles, or fluorescent lights. If you have not mounted it on the wall, try moving your HDTV to another location to see if this is the cause of the problem.</li> </ul>
The picture has abnormal patterns.	<ul style="list-style-type: none"> <li>• Check the connections of external devices that may be connected to the HDTV.</li> <li>• Make sure the specifications of external devices meet the specifications of your HDTV (like resolution).</li> <li>• If you are using an antenna, the signal strength of the channel may be low. Make sure your antenna is connected securely to the TV and move the antenna around the room or close to a window.</li> </ul>

General TV Problems	Solution
The display image does not cover the entire screen.	<ul style="list-style-type: none"> <li>• If you are in RGB mode (Computer), make sure that H-Size and V-Position in the On Screen Display (OSD) are set correctly.</li> <li>• If you are using TV, AV1, or AV2 with 480i input, press the WIDE button on the remote control to scroll through various screen modes.</li> </ul>
You can see a picture but you cannot hear sound.	<ul style="list-style-type: none"> <li>• Press Volume + (Up) on the remote control.</li> <li>• Press MUTE on the remote control to make sure that MUTE is not ON.</li> <li>• Check your audio settings. The audio may be set to SAP, or the speakers are set to off.</li> <li>• Check the audio connections of external devices that may be connected to the HDTV.</li> </ul>
The TV has pixels (dots) that are always dark or colored.	<ul style="list-style-type: none"> <li>• Your HDTV is manufactured using an extremely high level of precision technology, however, sometimes some pixels of your HDTV may not display. Pixel defects within industry specifications are inherent to this type of product and do not constitute a defective product.</li> </ul>
You see “noise” or “trash” on the screen.	<ul style="list-style-type: none"> <li>• When your HDTV’s digital capabilities exceed a digital broadcast signal, the signal is up-converted (increased) to match your TV’s display capabilities. Up-converting can cause noise or trash.</li> <li>• If you are using an antenna, the signal strength of the channel may be low. Make sure your antenna is connected securely to the TV and move the antenna around the room or close to a window.</li> </ul>
You switch to a different input and the volume changes.	<ul style="list-style-type: none"> <li>• The TV remembers the volume level from the last time you adjusted it. If the sound level is higher or lower from another source, then the volume will change.</li> </ul>
You switch to a different input and the screen size changes.	<ul style="list-style-type: none"> <li>• The TV remembers the viewing mode from the last time you used a particular input (AV, HDMI and TV).</li> </ul>
Tips for High-Definition Users.	<ul style="list-style-type: none"> <li>• Your HDTV is an ideal platform for viewing High Definition Content.</li> <li>• Best image quality will be achieved by HDMI.</li> <li>• Due to variances in broadcast practices, it is possible some image distortions can occur.</li> </ul>
Tips for Letterbox Content Users.	<ul style="list-style-type: none"> <li>• Some Letterboxed (or “Widescreen”) versions of DVD movies are formatted for standard 4:3 Televisions. Your HDTV has the ability to expand this content so the entire screen is filled at the expense of image accuracy. To use this function, press ZOOM on the remote control to cycle among the options.</li> </ul>

Media Viewer Problems	Solution
USB device is not recognized.	<ul style="list-style-type: none"> <li>• Make sure the device is correctly inserted.</li> <li>• Make sure the device is FAT or FAT32</li> <li>• Make sure it contains the supported files.</li> </ul>
Image or sound is interrupted or distorted.	<ul style="list-style-type: none"> <li>• Make sure the device is correctly inserted.</li> <li>• Make sure that the file complies with the supported format, bit rate and/or profile. Also check the file for damage.</li> <li>• Some files that comply with the supported format may not play back or display properly.</li> </ul>
Slideshow doesn’t start.	<ul style="list-style-type: none"> <li>• Make sure the viewer isn’t in pause, rotation, or zoom mode.</li> </ul>

## Telephone & Technical Support

Products are often returned due to a technical problem rather than a defective product that may result in unnecessary shipping charges billed to you. Our trained support personnel can often resolve the problem over the phone. For more information on warranty service or repair, after the warranty period, contact our Support Department at the number below.

Customer support and quality service are integral parts of VIZIO's commitment to service excellence.

For technical assistance contact our VIZIO Technical Support Department via email or phone.

Email: [techsupport@VIZIO.com](mailto:techsupport@VIZIO.com)

(877) 698-4946 Fax: (949) 585-9563

Hours of operation: Monday - Friday: 6 am to 9 pm

Saturday – Sunday: 8 am to 4 pm

Have your VIZIO model number, serial number, and date of purchase available before you call.

### VIZIO

Address:

39 Tesla

Irvine, CA 92618, USA

Telephone: (888) 849-4623 (949) 428-2525 Fax: (949) 585-9514

Web: [www.VIZIO.com](http://www.VIZIO.com)

## Compliance

Caution: Always use a power cable that is properly grounded. Use the AC cords listed below for each area.

**USA:** UL

**Canada:** CSA

**Germany:** VDE

**UK:** BASE/BS

**Japan:** Electric Appliance Control Act

**Mexico:** NOM

## FCC Class B Radio Interference Statement

NOTE: This equipment has been tested and found to comply with the limits for a Class B digital device, pursuant to Part 15 of the FCC Rules. These limits are designed to provide reasonable protection against harmful interference in a residential installation. This equipment generates, uses and can radiate radio frequency energy, and if not installed and used in accordance with the instructions, may cause harmful interference to radio communications. However, there is no guarantee that interference will not occur in a particular installation. If this equipment does cause harmful interference to radio or television reception, which can be determined by turning the equipment off and on, the user is encouraged to try to correct the interference by one or more of the following measures:

1. Reorient or relocate the receiving antenna.
2. Increase the separation between the equipment and receiver.
3. Connect the equipment into an outlet on a circuit different from that to which the receiver is connected.
4. Consult the dealer or an experienced radio/TV technician for help.

Notice:

1. The changes or modifications not expressly approved by the party responsible for compliance could void the user's authority to operate the equipment.
2. Shielded interface cables and AC AC/DC power adapter, if any, must be used in order to comply with the emission limits.

3. The manufacturer is not responsible for any radio or TV interference caused by unauthorized modification to this equipment. It is the responsibilities of the user to correct such interference.

## Chapter 10 Specifications

Product specifications may change without notice or obligation.

E 260VP		Specifications
Panel	26.1" Diagonal, 16:9 Aspect Ratio	
Resolution	1920 x 1080 pixels	
Pixel (Dot) Pitch	0.3mm(H) x 0.3mm(V)	
Display Compatibility	1080P (FHDTV)	
Colors	16.7 million	
Brightness cd/m2 (typical)	350 nits	
Contrast	1000:1	
Response Time	8ms (typical)	
Viewing Angle	178° (horizontal/vertical)	
Inputs	2 x HDMI with HDCP 1 x RF 1x Composite Video and Stereo Audio, 1x Component and Stereo Audio (Shared) 1x Computer RGB plus Stereo Audio 1x USB	
Outputs	1x 5.1 S/PDIF Optical Digital Audio, 1x Headphone	
Features	60 Hz E-LED panel, 1080P FHDTV, HDMI v1.3, 3D Comb Filter, Digital Audio Amplifier, Dolby Digital for ATSC/QAM, Signal Compatibility: 480I(SDTV), 480P(EDTV), 720P(HDTV), 1080I(HDTV), 1080P(FHDTV), Channel Skip/Add, VIDEO/INPUT Naming Capability, Closed Caption, Parental Control/V-CHIP 2.0, Programmable Timer,SRS TSHD,SRS TruVolume ,HD Game Port, Noise Reduction, MTS Stereo Decoder, Dolby Digital for ATSC/QAM, VESA Mount Compatible,Multimedia(JPEG only)	
Technical Features	ATSC/Clear QAM tuner, NTSC video decoding, 3:2 or 2:2 reverse pull-down, Motion adaptive de-interlace, Progressive video scan via VGA/HDMI, FHDTV via HDMI, Color temperature adjustments of 6500K/9300K/11000K, Independent Red/Green/Blue adjustments for color temperature fine tuning, Signal Compatibility 480i (SDTV), 480P (EDTV), 720P (HDTV), 1080i (HDTV), 1080P (FHDTV), Computer support at 640x480/800x600/1024x768/ 1920x1080 via VGA/HDMI	
Special Features	<ul style="list-style-type: none"> <li>• Multimedia: support JPG only</li> <li>• HDMI CEC</li> <li>• Detachable base</li> </ul>	
Speakers	2xBuilt-in, 5W Speakers	
Panel Life	50,000 hours to half the original brightness	
<b>Power</b>		
Input	IEC Connector for direct power line connection	
Voltage Range	100~240 Vac at 50/60Hz	
Power Consumption	32.8 (Avg), <1W (standby)	

E 260VP		Specifications
Environmental Conditions		
Dimensions	25.24" W x 17.95" H x 6.68" D with stand; 25.24" W x 15.90" H x 1.34" D without stand 641 x 456 x 170mm with stand; 641 x 404 x 34mm without stand	
Net Weight	9.7 lbs without stand; 10.14 lbs with stand 4.4 kg without stand; 4.6 kg with stand	
Gross Weight	16.98 lbs; 7.7 kg	
Certifications	CSA, CSA-US, FCC Class B	
Compliances	Energy Star 4.1. ATSC Spec A/65, EIA/CEA-766-A	

**Note:** The Federal Communications Commission (FCC), the Consumer Electronics Association (CEA) and the Consumer Electronics Retailers Coalition (CERC) have made a new tip sheet available for digital television (DTV) retailers to reproduce and distribute to consumers on the sales floor. The file may be downloaded online at [www.dtv.gov](http://www.dtv.gov). While you're there, check out the other useful information in the FCC is making available to consumers interested in learning more about the analog to digital transition.



### Preset PC Resolutions

If connecting to a PC through the RGB PC input, set the TV timing mode to VESA 1920x1080 at 60Hz for best picture quality (refer to the graphic card's user guide for questions on how to set this timing mode). See the table below for the factory preset resolutions.

Mode No.	Resolution	Refresh Rate (Hz)	Horizontal Frequency (KHz)	Vertical Frequency (Hz)	Horizontal Sync Polarity (TTL)	Vertical Sync Polarity (TTL)	Pixel Rate (MHz)	Remark
1	640 x 480	60	31.469	59.941	N	N	25.175	Windows
2	640 x 480	75	37.500	75.000	N	N	31.500	Windows
3	800 x 600	60	37.879	60.317	P	P	40.000	Windows
4	800 x 600	72	48.077	72.188	P	P	50.000	Windows
5	800 x 600	75	46.875	75.000	P	P	49.500	Windows
6	1024 x 768	60	48.363	60.004	N	N	65.000	Windows
7	1024 x 768	70	56.476	70.069	N	N	75.000	Windows
8	1024 x 768	75	60.023	75.029	P	P	78.750	Windows
9	720 x 400	70	31.469	70.087	N	P	28.322	DOS
10	Ⓢ1920 x 1080	60	66.587	59.934	P	N	138.50	Windows

**Note:** P: positive, N: negative, Ⓢ: Primary mode

### Resolution through RGB Input

If your PC supports VESA Reduce Blanking timing via the VGA card drive program (usually offered by the VGA Card Manufacturer), your TV set is equipped to have the 1920x1080 resolution display through this connection using the following timing 138.5MHz. The following parameters are often the values required by the software or programs to set up the display:

Parameters	Horizontal Values (Pixels)	Vertical Values (Lines)
Address	1920	1080
Front Porch	48	3
Sync Width	32	5
Back Porch	80	23
Total	2080	1111
Frequency	66.587 KHz	59.934 Hz
Sync Polarity	P	N
Pixel Rate (MHz)	138.5	
Refresh Rate (Hz)	60	

## Warranty

### ONE-YEAR LIMITED WARRANTY ON PARTS AND LABOR

*(Covers units purchased as new in United States and Puerto Rico Only)*

VIZIO provides a warranty to the original purchaser of its products against defects in materials and workmanship for a period of one year of non-commercial usage and ninety (90) days of commercial use. If a VIZIO product is defective within the warranty period, VIZIO will either repair or replace the unit at its sole option and discretion.

To obtain warranty service, contact VIZIO Technical Support via email: [TechSupport@VIZIO.com](mailto:TechSupport@VIZIO.com) or via phone at 877 MY VIZIO (877.698.4946) from 6:00AM to 9:00PM Monday through Friday and 8:00AM to 4:00PM Saturday and Sunday, Pacific Time, or visit [www.VIZIO.com](http://www.VIZIO.com). Proof of purchase in the form of a purchase receipt or copy thereof is required.

#### Parts and Labor

There will be no charge for parts or labor during the warranty period. Replacement parts and units may be new or recertified at VIZIO's option and sole discretion. Replacement parts and units are warranted for the remaining portion of the original warranty or for ninety (90) days from warranty service or replacement, whichever is later.

#### Types of Service

Units 30" or larger will usually be serviced in-home. In-home service requires complete and easy access to the unit and does not include de-installation or re-installation of the product. However, in some cases, it may be necessary to send the unit to a VIZIO service center. VIZIO will cover the transportation charges to and from the same customer location.

Units less than 30" must be sent to a VIZIO service center. VIZIO is not responsible for transportation costs to the service center, but VIZIO will cover return shipping to the customer. **PRE-AUTHORIZATION IS REQUIRED BEFORE SENDING ANY UNIT IN FOR SERVICE.**

Any returns to VIZIO's service centers must utilize either the original carton box and shipping material or a replacement box and material provided by VIZIO. VIZIO technical support will provide instructions for packing and shipping the unit to the VIZIO service center.

#### Limitations and Exclusions

VIZIO's one-year limited warranty only covers defects in materials and workmanship. Items not covered include but are not limited to cosmetic damage, normal wear and tear, misuse, signal issues, power surges, and damages from shipping, acts of God, any sort of customer misuse, installation, customer modifications, adjustments, and set-up issues. Units with unreadable or removed serial numbers, "image burn-in", and routine maintenance are not covered. This warranty does not cover products sold "AS IS", "FACTORY RECERTIFIED", or by a non-authorized reseller.

THERE ARE NO EXPRESS WARRANTIES OTHER THAN THOSE LISTED OR DESCRIBED ABOVE. ANY IMPLIED WARRANTIES, INCLUDING ANY IMPLIED WARRANTY OF MERCHANTABILITY AND FITNESS FOR A PARTICULAR PURPOSE, SHALL BE LIMITED IN DURATION TO THE PERIOD OF TIME SET FORTH ABOVE. VIZIO'S TOTAL LIABILITY FOR ANY AND ALL LOSSES AND DAMAGES RESULTING FROM ANY CAUSE WHATSOEVER SHALL IN NO EVENT EXCEED THE PURCHASE PRICE OF THE DISPLAY. VIZIO SHALL NOT BE RESPONSIBLE FOR LOSS OF USE, COMMERCIAL LOSS, LOST REVENUE OR LOST PROFITS, OR OTHER INCIDENTAL OR CONSEQUENTIAL DAMAGES. SOME STATES DO NOT ALLOW LIMITATIONS ON HOW LONG AN IMPLIED WARRANTY LASTS OR THE EXCLUSION OF INCIDENTAL OR CONSEQUENTIAL DAMAGES, SO THE ABOVE LIMITATIONS OR EXCLUSIONS MAY NOT APPLY TO YOU. THIS WARRANTY GIVES YOU SPECIFIC LEGAL RIGHTS, AND YOU MAY ALSO HAVE OTHER RIGHTS, WHICH VARY FROM STATE TO STATE. THIS WARRANTY IS SUBJECT TO CHANGE WITHOUT NOTICE. CHECK [www.VIZIO.com](http://www.VIZIO.com) FOR THE MOST CURRENT VERSION.

#### Personal Data

If your VIZIO product is capable of storing personal data and other information, **ALL CONTENTS AND INFORMATION WILL BE DELETED IN THE COURSE OF SOME IN-HOME AND ALL SHIP-IN WARRANTY SERVICE.** If this occurs, your product will be restored to you configured **as originally purchased.** You will be **responsible for restoring all applicable data and passwords.** Recovery and reinstallation of user data is not covered under this Limited Warranty. **In order to protect your personal information, VIZIO recommends that you always clear all personal information from the unit before it is serviced, regardless of the servicer.**

#### ZERO BRIGHT PIXEL DEFECT GUARANTEE

This policy covers "zero bright pixel" defects for the duration of the limited "ONE YEAR WARRANTY" on select new product purchases. To determine if this guarantee applies to your product, refer to the "DETAILS" tab of the model's product information page ([www.VIZIO.com](http://www.VIZIO.com)) or look for the "zero bright pixel" guarantee on the box.

## Index

16:9 .....	31	Satellite Box .....	22
4:3 .....	31	EPG .....	19
Accessories .....	9	Getting Started .....	17
Adjustments		Grounding .....	4
Advanced .....	30	GUIDE Button .....	19
Volume .....	13	HDMI .....	20
Advanced Adjustments .....	30	HDTV Location .....	10
Ambient Light Sensor .....	34	Help Menu	
Antenna .....	20	Reset All Settings .....	42
Aspect Ratio .....	31	Setup Wizard .....	42
Audio Menu		System Info .....	42
Advanced Audio .....	35	Help Menu .....	42
Analog Audio Out adjustments .....	35	Horizontal/Vertical Position adjustments .....	33
Audio Mode adjustments .....	35	Input Source	
Balance adjustments .....	35	Choosing .....	18
Digital Audio Out .....	35	Inputs	
Equalizer adjustments .....	36	Antenna .....	4
Lip Sync adjustments .....	35	Connectors .....	20
Reset Audio Mode .....	36	Jag Wheel .....	13
Speaker adjustments .....	35	Maintenance of TV .....	43
SRS TruVolume .....	35	Media Menu	
SRS TSHD (surround sound) adjustments .....	35	Duration .....	29, 41
AV connector .....	20	Info .....	29, 41
Blackbars .....	31	Repeat .....	29, 41
Blocking Channels .....	38	Slideshow .....	29, 41
Brightness .....	32	Slideshow Effect .....	29, 41
Cable Box		Sort By .....	29, 41
Connecting .....	21	Thumbnail Size .....	29, 41
CC Closed Caption .....	32	Media Menu .....	41
CEC .....	40	Menu Language .....	40
Cleaning .....	43	Name Input .....	37
Color .....	33	OSD .....	30
Composite Connector .....	20	CC Menu .....	32
Computer		Help Menu .....	42
Connecting .....	26	Input Menu .....	30
Preset Resolutions .....	49	Media Menu .....	41
Resolution through RGB .....	49	Picture Menu .....	32
Connecting		Settings Menu .....	36
Computer .....	26	Sleep Timer Menu .....	32
RGB .....	26	Wide Menu .....	31
VGA .....	26	Parental Controls	
Connecting Equipment		Alt Rating Region .....	39
Cable .....	21	Block Unrated TV .....	39
DVD .....	23	Canadian English Rating .....	39
Rear Panel Connections .....	14	Canadian French Rating .....	39
Satellite Box .....	21	Change the Password .....	40
Sound system .....	26	Channel Block .....	38
Stereo .....	26	Reset Locks .....	40
VCR .....	25	USA Movie Rating .....	39
Video Camera .....	25	USA TV Rating .....	38
Contents .....	9	Parental Controls .....	38
Contrast .....	33	Password .....	40
Controls		Photos	
Front Panel .....	13	Adjusting Settings .....	29
Jag Wheel .....	13	Viewing .....	28
Daylight Savings setting .....	40	Picture	
DTV Transition .....	5	Reset Picture Mode .....	34
DVD Player		Picture Menu .....	32
Connecting .....	23	Adaptive Luma .....	34
DVI		Advanced Video .....	34
Cable Box .....	22	Ambient Light Sensor .....	34

Backlight .....	32	Setup Wizard.....	17
Backlight Control .....	34	Sharpness .....	33
Brightness .....	32	Skip Channel.....	37
Color .....	33	Slideshow	
Color Enhancement .....	34	Duration .....	29, 41
Color Temperature .....	34	Effect.....	29, 41
Contrast .....	33	Mode .....	29, 41
Film Mode .....	34	Repeat .....	29, 41
Noise Reduction.....	34	Specifications .....	47
Picture Mode.....	32	Stereo	
Sharpness.....	33	Connecting .....	26
Tint.....	33	Technical Support .....	46
Pictures		Time Zone setting .....	40
Adjusting Settings .....	29	Tint.....	33
Create Slideshow.....	29, 41	Troubleshooting .....	43
Info .....	29, 41	Tuner Menu	
Sort .....	29, 41	Analog MTS .....	37
Thumbnail Size .....	29, 41	Auto Search .....	36
Viewing .....	28	Skip Channel.....	37
Remote Control.....	15	Tuner Mode.....	36
Batteries.....	15	TV Menu .....	30
Buttons.....	16	Partial Channel Search .....	36
Precautions .....	15	TV Stand	
Range .....	15	Attaching .....	11
Safety Instructions.....	2	USB Port .....	28
Satellite Box		VCR	
Connecting.....	21	Connecting.....	25
Search for channels .....	36	Video Camera	
Setting Up .....	10	Connecting .....	25
Settings Menu		Wall mounting .....	12
Audio.....	35, 37	Warranty .....	50
CEC .....	40	Watching TV	
Menu Language .....	40	Getting your Programs .....	18
Parental Controls Menu .....	38	Program Information .....	19
Time & Local Settings .....	40	Wide.....	31
Tuner.....	36	Wizard.....	42